

CERAMIC TILING

- HF-01**
600 x 300 DARK GREY CERAMIC FLOOR TILE TO SHOWROOM
- HF-01A**
AS HF-01 BUT COLOUR (LIGHT GREY)
- HF-02**
200 x 200 LIGHT GREY CERAMIC HEAVY DUTY FLOOR TILE TO WORKSHOP
- HF-02A**
AS HF-02 BUT COLOUR (DARK GREY)
- HF-02B**
AS HF-02 BUT WITH EPOXY GROUT
- HF-03**
300 x 300 DARK GREY SPECKLED FLOOR TILE TO BASEMENT 1 AREAS INCLUDING WCs
- HF-04**
95 x 300 CERAMIC SKIRTING TILE TO CARPETED AREAS
- HF-05**
200 x 200 OFF-WHITE CERAMIC WALL TILE TO BASEMENT WORKSHOP AREAS AND WCs
- HF-05A**
AS HF-05 BUT COLOUR BLACK
- HF-06**
300 x 300 LIGHT GREY CERAMIC WALL TILE TO WC AREAS

GLAZED SCREENS

- BESPOKE**
- GL-03**
1500MM HIGH GLASS PRIVACY SCREEN
- GL-04**
FULL HEIGHT GLAZED PARTITION TO ATRIUM VOID
- GL-05**
2.1M HIGH FRAMELESS GLAZED PARTITION
- GL-06**
FULL HEIGHT GLAZED PARTITION
- GL-06A**
FRAMELESS GLAZED SINGLE DOOR
- GL-06B**
FRAMELESS GLAZED DOUBLE DOOR

PROPRIETARY

- IWS-18**
SINGLE GLAZED WINDOW

DRYLINING / PARTITIONS

- IWS-12**
NON FIRE RATED PARTITION
- IWS-12A**
NON FIRE RATED MOISTURE RESISTANT PARTITION
- IWS-12B**
NON FIRED RATED PARTITION MOISTURE RESISTANT ON JUMBO STUDS
- IWS-13**
60MIN FIRE RATED PARTITION
- IWS-14**
NON FIRE RATED WALL LINING ON JUMBO STUDS
- IWS-15**
1500MM HIGH PARTITION WITH TIMBER CAPPING
- IWS-16**
NON FIRE RATED WALL LINING

CUBICLE & DUCT PANNELLING

- PAN-01**
WC CUBICLE SYSTEM TO BASEMENT LEVELS
- PAN-02**
WC CUBICLE SYSTEM TO ABOVE GROUND AREAS
- PAN-03**
2.1M HIGH WC DUCT PANNELLING SYSTEM
- PAN-03B**
FULL HEIGHT WC DUCT PANNELLING SYSTEM

CARPET / VINYL/ TIMBER FLOORS

- FL-02**
HEAVY DUTY VINYL FLOORING
- FL-04**
CARPET TILING TO BELOW GROUND OFFICES
- FL-05**
CARPET TILING TO ABOVE GROUND OFFICES
- FL-06**
TIMBER FLOORING

METAL ACCESSORIES

- FX-01**
25x25 S/S CORNER PROTECTOR
- FX-01A**
50x50 S/S CORNER PROTECTOR
- FX-04**
S/S HANDRAIL

B2/B1 TILE SETTING OUT

- NOTE:**
SETTING OUT POINT TO CENTRE OF TILE.
- WHERE TILING GRID CHANGES BETWEEN SETTING OUT POINTS, CUT TILES ARE NOTED. (GENERALLY AT DOOR THRESHOLDS)

M & E SYMBOLS

- FB**
M&E FLOOR GROMMET: POWER
- FB1**
M&E FLOOR BOX: POWER / DATA
- HW**
M&E HARD WIRED: POWER / DATA

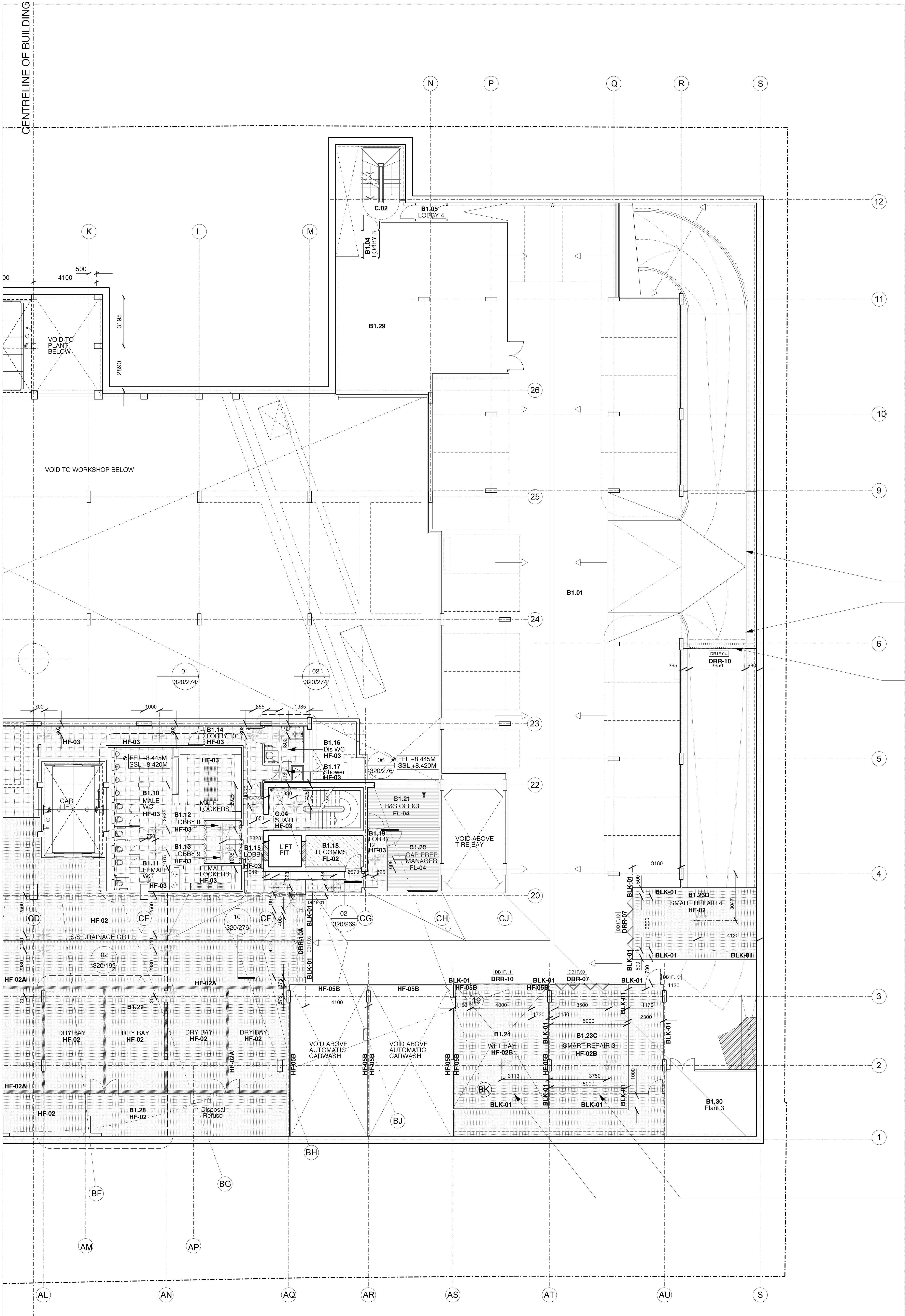

S&C
EXISTING KERB LINE
STRAIGHTENED
EXISTING TRANSITION
GRADIENTS REMAIN THE SAME

DRR-10
NEW FAST ACTING SHUTTER
IN FRONT OF B1 SECURITY SHUTTER

S&C
EXISTING BLOCKWORK WALL
DEMOLISHED

Rev	Date	Description	By	Chkd	App	Do not Scale. Used figured dimensions only. All dimensions to be checked on site
C	05.06.08	FIRST STAGE TENDER ISSUE	AW	CF	SR	All drawings to be read in conjunction with the Engineers' drawings. Any discrepancies between consultants drawings to be reported to the Architect before any work commences.
D	20.06.08	SECOND STAGE TENDER ISSUE: CEILINGS, PARTITIONS & DOOR PACKAGES	AW	CF	SR	The Contractor's attention is drawn to the Health & Safety matters identified in the Health & Safety plan as being potentially hazardous. These items should not be considered as a complete and final list. The Work Package Contractor's normal Health and Safety obligations will apply when undertaking constructional operations both on and off site.
E	04.07.08	SECOND STAGE TENDER ISSUE: FLOOR FINISHES, SCAFFOLD & INSULATION PACKAGES	AW	CF	SR	
F	20.07.08	CONSTRUCTION: CEILINGS, PARTITIONS & DOOR PACKAGES	AW	CF	SR	
G	10.09.08	CONSTRUCTION ISSUE: BASEMENT SHUTTERS AND VEHICLE BARRIERS	AW	CF	SR	
H	16.10.08	CONSTRUCTION ISSUE: AMENDMENTS TO WET/DRY BAYS	AW	CF	SR	The Show Rising Ramps, Ground floor slab and B2 slab shall be constructed to exclude water to achieve a Grade 2 basement as defined in BS 8102 (1996).

CONSTRUCTION ISSUE

FIT OUT

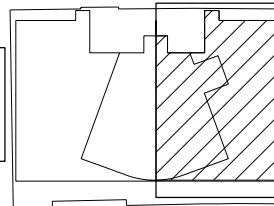

24 Briston Street
London EC1M 5UA

+44 (0) 20 7608 7900 T
+44 (0) 20 7608 7901 F
info@wilkinsoneyre.com

WilkinsonEyre.Architects

Project	AUDI WEST LONDON	Drawn/Chkd	App
Title	B1 FIT OUT INTERNAL FINISHES PLAN 2 / 2	AR	AS/ SR
WE Job No.	320	Date	13.04.06
Scale	Scale: 1:200	Scale: 1:100	Scale: 1:100
Drawing no.	WE- 320-163	Rev.	H

© Copyright WilkinsonEyre Architects Ltd