

① ground floor lift fronts elevation
read in conjunction with core plan dwg A2003 & A2110

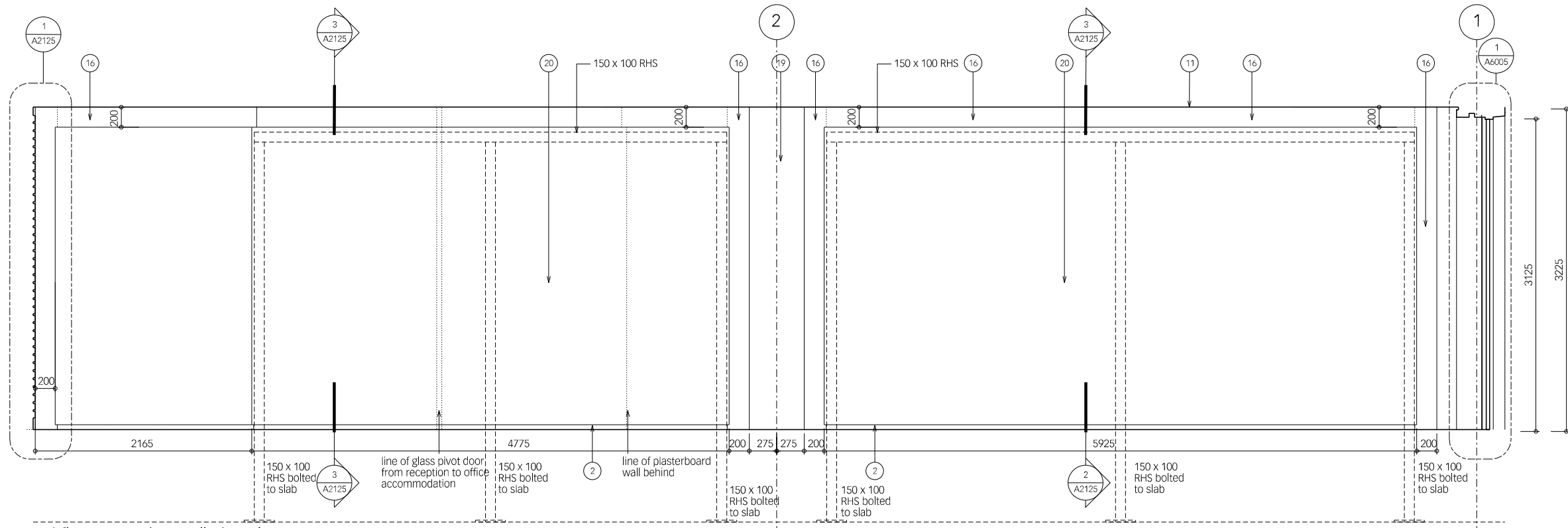

② ground floor reception wall elevation
read in conjunction with core plan dwg A2003 & A2110

date	rev	revisions
23.06.06	A	elevations updated, dimensions & cross references added, drawing title amended
27.07.07	B	Issued for construction
28.03.08	C	Supply and extract risers revised in line with Meica services redesign. Extract grillage at high level lift front wall moved from above fire panel to over stair escape door. Stair core 1 access door ref. corrected. Structural goalposts added to plasterboard reception walls in line with SE drawings. Concrete core wall openings shown dotted on elevations.
05.02.09	D	Riser door DG 015 at grid ref 7-3 added and Riser door DG 002 relocated at IntechMeica request.
13.02.09	E	Riser door DG 015 at grid ref 7-3 omitted.
13.03.09	F	Riser door DG 015 at grid ref 7-3 reinstated at IntechMeica request.

notes: for all specification references regarding the building envelope refer to building envelope specification

architect

Lifschutz Davidson Sandilands
Island Studios, 22 St. Peter's Square, London W6 9NW T +44 (0)20 8600 4800 F +44 (0)20 8600 4700 mail@lds-uk.com

project	drawing title			
16-19 Gresse Street, London, W1	ground floor feature wall and reception elevations			
client	scale at A1	scale at A3	drawn	date
Derwent Valley Holdings	1:25 / 5	1:50 / 10	EM	01.06
job no.	drawing	rev.		
0382A	A2120	F		

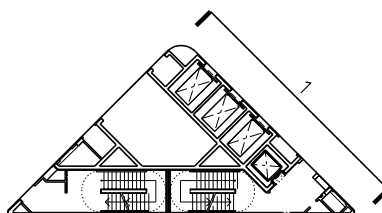

KEY:	
1. white painted (M60/175) MDF wall panel (K13/151)	12. SS lifts fronts with alternating horizontal bands of 60mm satin finished ss & 20mm mirror polished SS (K13/155)
2. 50mm white pvc skirting (M50/770)	13. SS overpanel with alternating horizontal bands of 60mm satin finished SS & 20mm mirror polished SS (K13/155)
3. white laminate faced door with vision panel (L20/416)	14. Profiled GRP double skin sandwich panels with foam core (H41/120) with satin ss strips fixed within horizontal recess (Z11/110)
4. 21mm painted (M60/150) MDF riser doors (K11/875) (refer to dwg A4203 & A4204)	15. Toughened laminated glass partition (L40/351) rebated into concrete soffit / column and partition head
5. PCC finished (M60/145) linear bar air grille (P20/141)	16. Slots formed on panel for reception air extract
6. Satin finished SS centrally opening lift doors	17. Cast clear acrylic signage (refer to dwg A3512)
7. Satin finished SS full length architrave (K13/115) (Z11)	18. Satin finished SS tenant signage (refer to dwg A3605)
8. Satin finished SS full length architrave (K13/115) (Z11)	19. Painted (M60/182) fair faced column
9. Solid sand blasted acrylic lift direction indicators bonded to ss box frame slotted into ss sleeve (refer to drawing A3115)	20. white painted (M60/172 plasterboard wall (K10/165)
10. Lift call buttons (refer to dwg A3115)	
11. Spray applied plaster finish (M22/120)	
This drawing is the property of Lifschutz Davidson Ltd. No disclosure or copy of it may be made without the written permission of Lifschutz Davidson Ltd.	