

13.02.29	Riser door setting out relative to Intermecnia requirements. Riser door D101 reduced in size and relocated. Riser door D103 on level 10 relocated. Riser door D1022 omitted on all floors except 6th, and there only one leaf required. At the 2nd, 10, full height extract grille fire damper and lower level access panel behind grille added. Access panel set to 1155 and set to 1350mm below FFL to centre of panel.
13.03.29	Riser door setting out relative to Intermecnia requirements. One corner riser door on levels 12, 13 & 5th floor removed, removable roof facing panels concealing a fixed dry riser wall with 450x550mm access panels at the 1st-5 and high low levels set out to Intermecnia access requirements.
18.02.29	4th floor dry risers and outfalls at roof height indicated 5th floor floor only WAP added in 1st floor hallway. All details to be confirmed.
13.03.29	Riser 4 door layout revised relative to maxima services access requirements

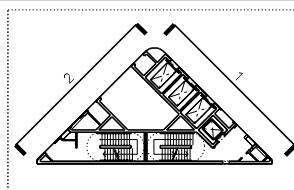

read in conjunction with color plan ACO05	
Key:	
1. white painted M60/172 MDF wall panel (K31/151)	11. Spray applied colored finish
2. 50mm white pvc skirting (A20/146)	12. 35 KLF fronts with alternating horizontal bands of 40mm satin finished ss & 20mm mirror polished SS (K31/155)
3. white laminate floor with vision panel (L20/146)	13. SS overlapped with alternating horizontal bands of 40mm satin finished SS & 20mm mirror polished SS (K31/155)
4. 25mm painted M60/150 MDF riser corner (K1/1675)	14. profiled GRP double ss sandwich with foam core K4/1/210 with satin ss strips fixed with vertical horizontal necess (Z11/110)
5. white painted M60/150 MDF corner (K1/1675)	
6. KCC insulated 100mm base air gap	
7. satin finished SS fully opening lift doors	
8. satin finished SS length alignment (K31/155) (Z11)	
9. door cast A316	
10. satin finish overlapped panel (refer to door A316)	15. To hygienic laminate glass partition (L4/251) rebated into profiled SS (Z11/110) and partition frame
11. Solid sand blasted acrylic lift direction indicators bonded to box frame scribed into ss sleeve refer to door A315	16. Slits formed on GRP panel for reception air extract
12. satin finish (refer to door A315)	17. Cast clear acrylic signage refer to drawings A315/2
13. 25mm white pvc skirting (A20/146)	18. satin finish SS frame signage refer to drawings A315/2
14. 25mm white pvc skirting (A20/146)	19. 25mm white pvc skirting (A20/146) (refer to drawing L20/146)

This drawing is the property of the client. No disclosure or copy of this drawing is to be made without the written consent of the client.

Lifschutz Davidson Sandilands

project  
16-19 Gresse Street, London, W1

scale at A1	scale at A3	drawn	date
1:25	1:50	GF	01.06
job no.	drawing	rev.	
0382A	A2130	G	

Derwent Valley Holdings

1:25	1:50	GF	01.06
------	------	----	-------

0382A	A2130	G
-------	-------	---