

01  
2035  
SECTION DETAIL  
HEAD OF FIXED GLAZING

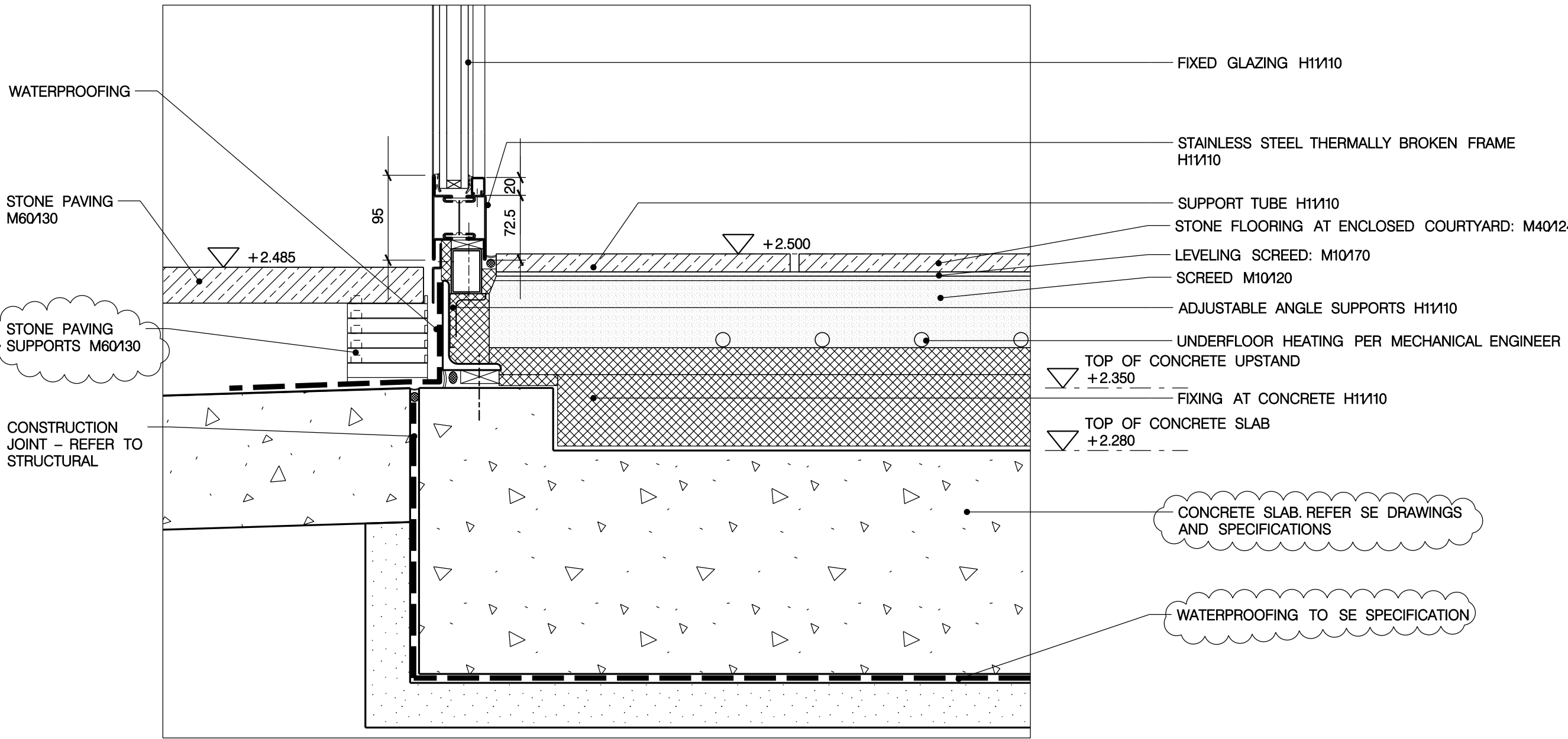

02  
2035  
SECTION DETAIL  
HEAD OF DOOR B12-1 AND OPERABLE WINDOW



03  
2035  
SECTION DETAIL  
SILL OF FIXED GLAZING

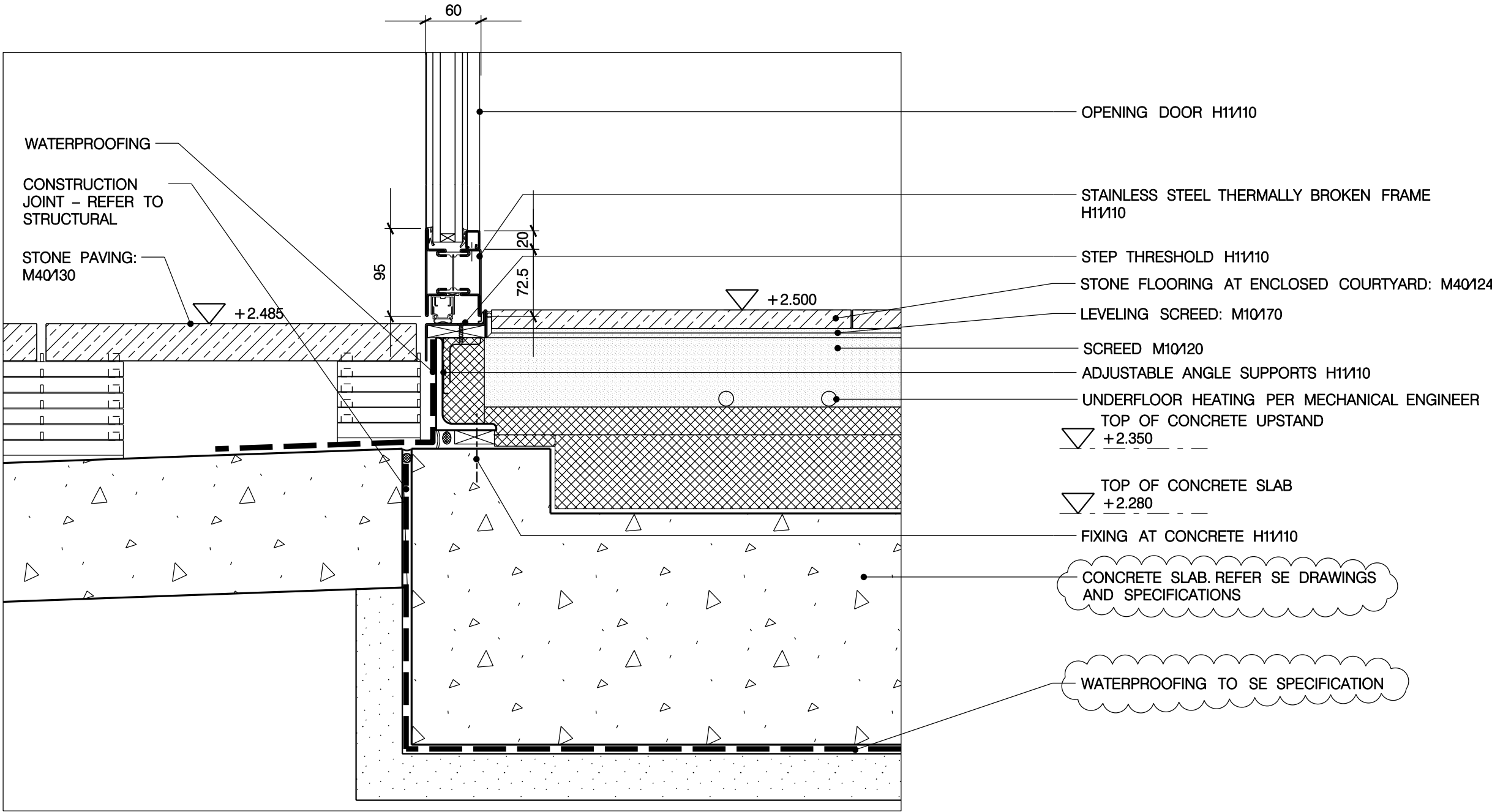

04  
2035  
SECTION DETAIL  
THRESHOLD OF DOOR B12-1

GENERAL NOTES

- GN1. DRAWINGS TO BE READ IN CONJUNCTION WITH ALL ENGINEERS' & SPECIALISTS' DRAWINGS & ALL SPECIFICATIONS.
- GN2. DO NOT SCALE FROM THIS DRAWING.
- GN3. ALL DIMENSIONS TO BE VERIFIED ON SITE. FIGURED DIMENSIONS TO TAKE PREFERENCE ON THOSE SCALED.
- GN4. ALL LEVELS TO BE TO ORDINANCE DATUM UNLESS OTHERWISE SPECIFIED.
- GN5. DRAWINGS ARE THE PROPERTY OF IAN RITCHIE ARCHITECTS LTD. AND ARE ISSUED ON THE CONDITION THEY ARE NOT REPRODUCED, RETAINED OR DISCLOSED TO ANY UNAUTHORISED PERSON, EITHER WHOLLY OR IN PART WITHOUT WRITTEN CONSENT OF IAN RITCHIE ARCHITECTS LTD.
- GN6. ALL SERVICES SHOWN ARE INDICATIVE. WORKS TO BE COORDINATED WITH BUILDERS WORK AND INSTALLATION DRAWINGS.

DETAIL NOTES

LEGEND

- AMENDMENT
- IN ABEYANCE

K00	19.01.08	CR	Issued for Construction.
FOI	30.08.08	FF	Floor assemblies updated/issued for tender. Note 1 deleted.
FOI	12.09.08	FF	First issue - Refer to Note 1 above
Rev	Date	By	Description

Job Title  
NORTH HOUSE

Drawing Title  
Section Details  
Glazed Screen  
Enclosed Courtyard  
Sheet 16

IAN RITCHIE ARCHITECTS  
110 Three Colt Street London E14 8AZ  
Tel: 020 7338 1100 Fax: 020 7338 1199

0 50mm 100mm 150mm 200mm

Status  
CONSTRUCTION

Scale  
1:5 [A1]

Date  
12.09.08

Drawn FF	Checked TM	Approved AS
-------------	---------------	----------------

Job No 560	Drawing No IRAL-2035	Rev K00
---------------	-------------------------	------------