

TYPE A

Single timber door with vision panel

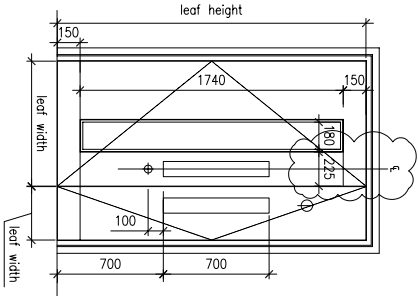

TYPE B

1.5 timber door with vision panel

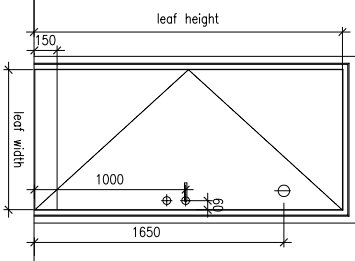

TYPE C

Single solid timber door

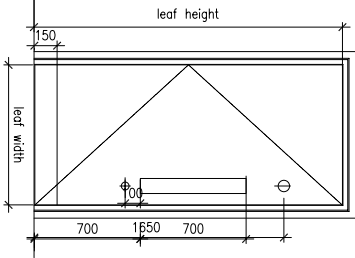

TYPE D

Single solid timber door

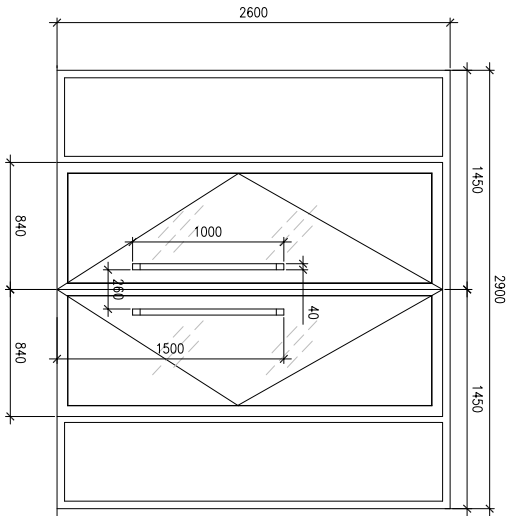

TYPE E

Double fire-rated glazed door - lift lobby
Provision for concealed mag lock in door head.

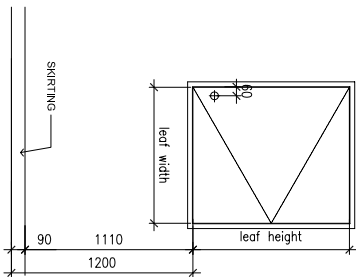

TYPE F

Aluminum bouwered panel

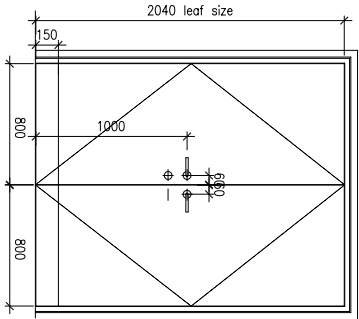

TYPE G

External double timber doors as per others with 3mm aluminum plate bounded to external face of door

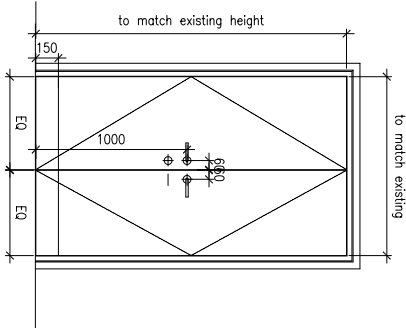

TYPE H

External double timber doors as per others with 3mm aluminum plate bounded to external face of door

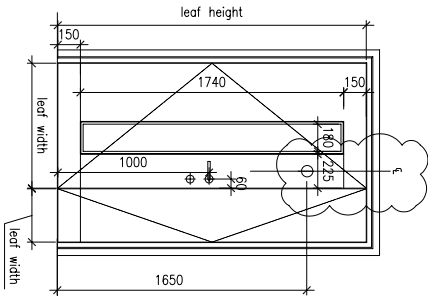

TYPE J

External 1.5 leaf timber door as per others with 3mm aluminum plate bounded to external face of door with vision panel

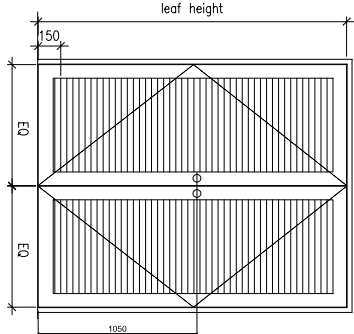

TYPE K

External aluminum bouwered door

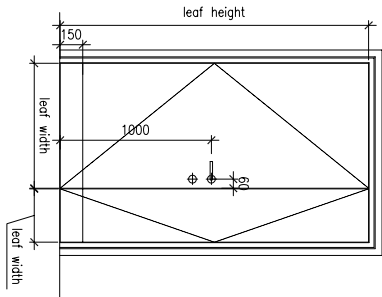

TYPE L

External 1.5 leaf timber door as per others with 3mm aluminum plate bounded to external face of door

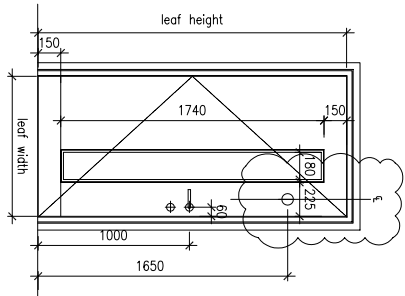

TYPE M

External 1.5 leaf timber door as per others with 3mm aluminum plate bounded to external face of door

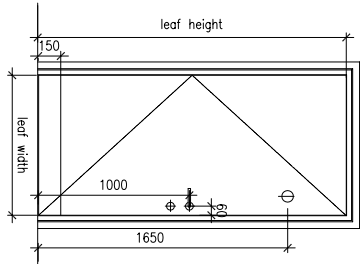

TYPE N

External single timber door as per others with 3mm aluminum plate bounded to external face of door

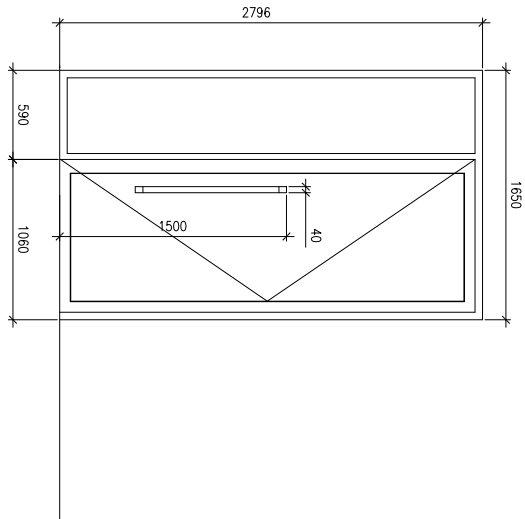

TYPE P

Double fire-rated glazed door - lift lobby
Provision for concealed mag lock in door head.

C	Drawn added and revised.	14.1.2006	mp	mp
B	Door type F revised. Note revised.	24.06.2006	ap	mp
A	Issued for construction	01.05.2006	ap	mp
I	Issued for tender	22.10.2007	ap	mp
Rev	Notes	ddmm/yyyy	By	Issue

FOR CONSTRUCTION

Do not scale from this drawing. Check all dimensions and notes on site.

darling associates

210 Pentonville Road

- London

- Door elevations
- Offices

Project No:	Drawing No:	Revision:
6007	(32)01	C
Scale:	1/25 @ A1	1/50 @ A3
Date:	2006.10.11	Drawn: AP
		Issue: MP

This drawing is the copyright of darling associates