

TYPE A

Single timber door with vision panel

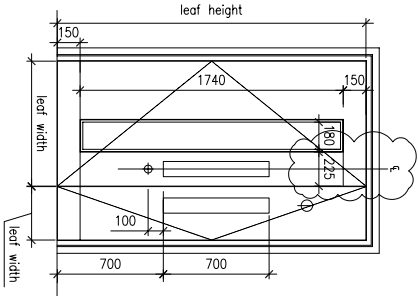

TYPE B

1.5 timber door with vision panel

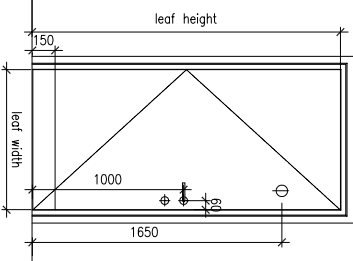

TYPE C

Single solid timber door

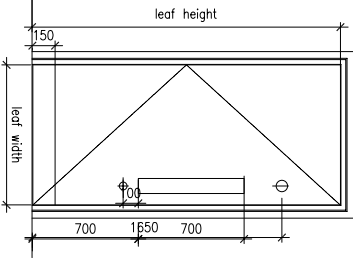

TYPE D

Single solid timber door

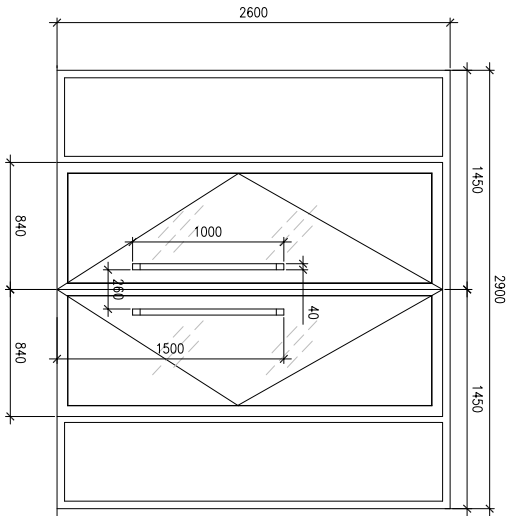

TYPE E

Double fire-rated glazed door - lift lobby
Provision for concealed mag lock in door head.

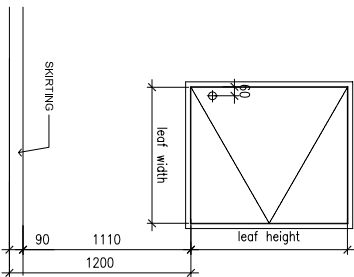

TYPE F

Aluminum bouwered panel

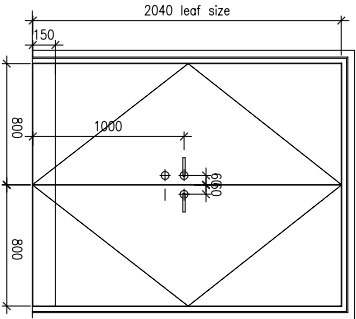

TYPE G

External double timber doors as per others with 3mm aluminum plate bounded to external face of door

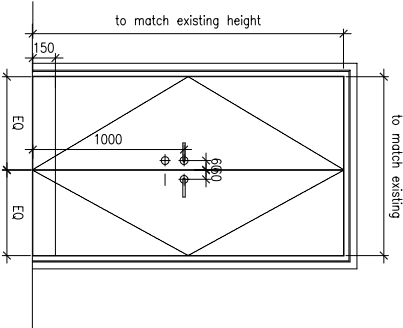

TYPE H

External double timber doors as per others with 3mm aluminum plate bounded to external face of door

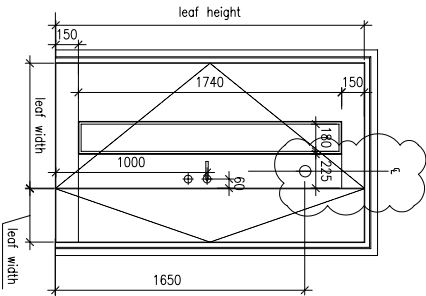

TYPE J

External 1.5 leaf timber door as per others with 3mm aluminum plate bounded to external face of door with vision panel

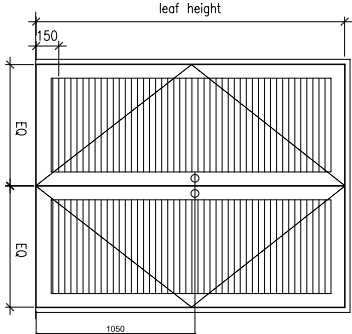

TYPE K

External aluminum bouwered door

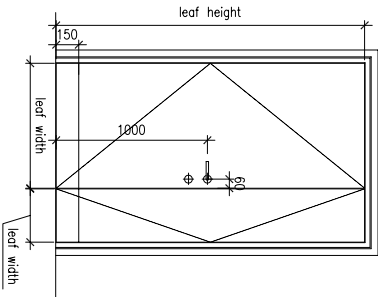

TYPE L

External 1.5 leaf timber door as per others with 3mm aluminum plate bounded to external face of door

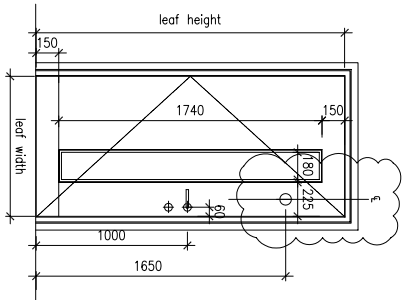

TYPE M

External 1.5 leaf timber door as per others with 3mm aluminum plate bounded to external face of door

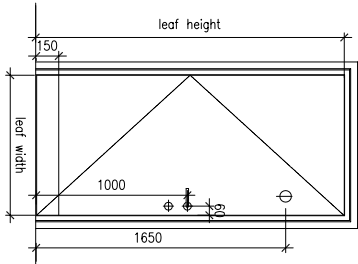

TYPE N

External single timber door as per others with 3mm aluminum plate bounded to external face of door

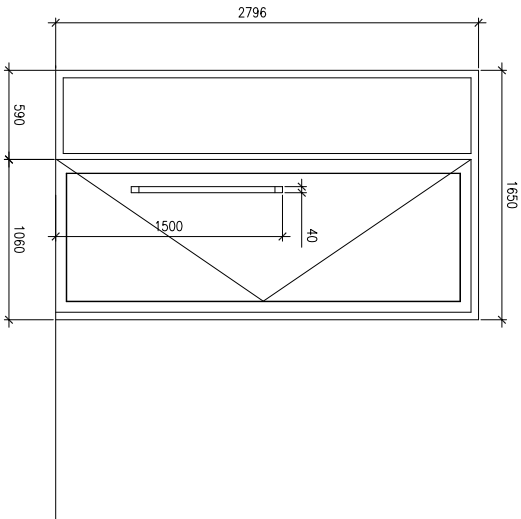

TYPE P

Double fire-rated glazed door - lift lobby
Provision for concealed mag lock in door head.

C Drawn and revised. 14.1.2006 mp

B Door type F revised. Note revised. 24.06.2006 mp

A Issued for construction 01.05.2006 mp

I Issued for tender 22.10.2007 mp

Rev Notes dcmm/yyyy By Issue

FOR CONSTRUCTION

Do not scale from this drawing. Check all dimensions and notes on site.

GREENGLASS HOUSE 18 FRANCES STREET LONDON SW1P 1JH
T: 020 7630 0500 F: 020 7630 9059 E: mail@darlingassociates.net

darling
associates

Project:

• 210 Pentonville Road

• London

Title:

• Door elevations

• Offices

Project No:

• 6007 • (32)01 • C

Scale: 1/25 @ A1 1/50 @ A3 C&O File No: KC/6007/Current/End(32)

Date: 2006.10.11 Drawn: AP Issue: MP

This drawing is the copyright of darling associates