

TYPE AA

Single timber door with vision panel

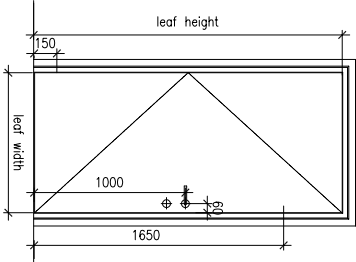

TYPE BB

Single solid timber door

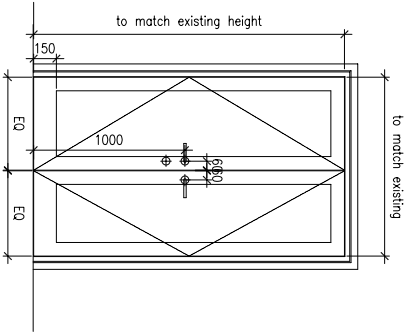

TYPE CC

Double solid timber door

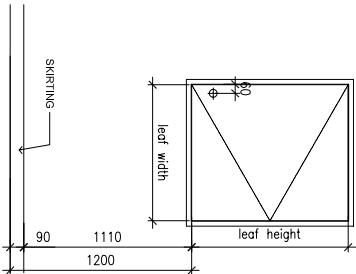

TYPE DD

Aluminum bowered panel

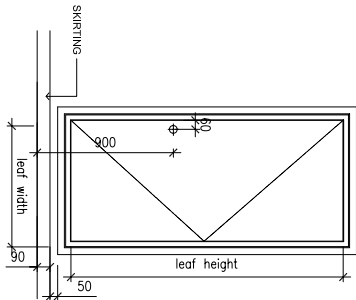

TYPE EE

Solid timber panel

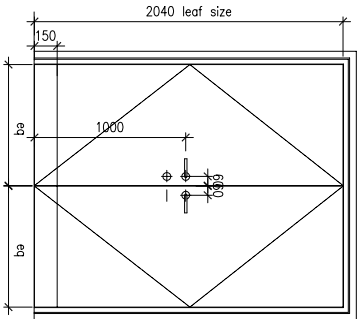

TYPE FF

External double timber doors as per others with 3mm aluminum plate bounded to external leaf of door

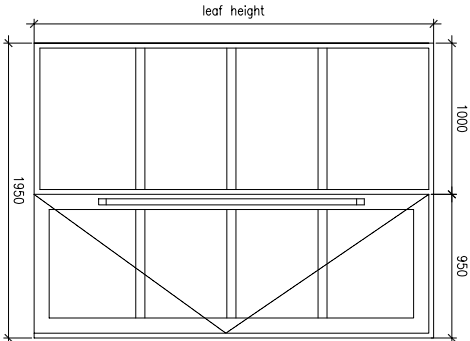

TYPE GG

External galvanneal steel & glass front entrance door

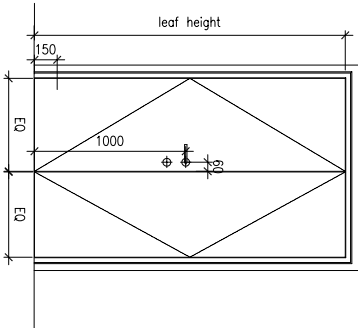

TYPE MM

Double solid timber door

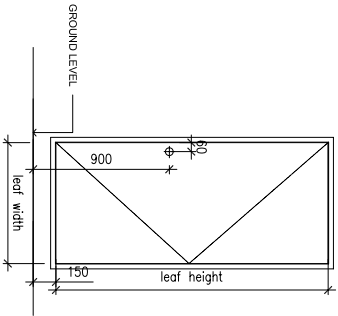

TYPE HH

External single timber doors as per others with 3mm aluminum plate bounded to external face of door

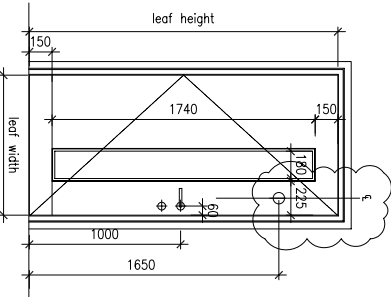

TYPE JJ

External 1/5 leaf timber door as per others with 3mm aluminum plate bounded to external face of door

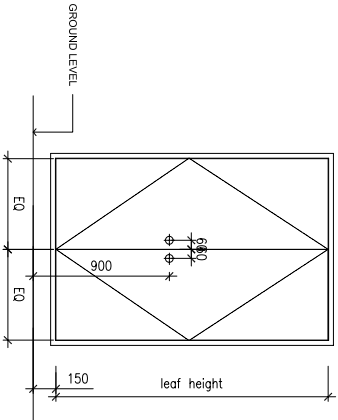

TYPE KK

External double timber doors as per others with 3mm aluminum plate bounded to external face of door

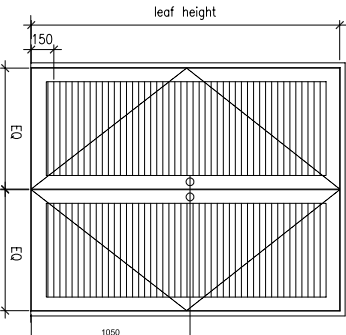

TYPE LL

External aluminum bowered door

E	Draws added and revised.	14.11.2008	ap	mp
D	Door type MM added.	24.10.2008	ap	mp
C	Door type LL added.	24.06.2008	ap	mp
B	Door type DD revised.	24.06.2008	ap	mp
A	Issued for construction	01.05.2008	ap	mp
I	Issued for tender	24.10.2007	ap	mp
Rev	Notes	dd/mm/yyyy	By	Issue

FOR CONSTRUCTION

Do not scale from this drawing. Check all dimensions and notes on site.

darling
associates

GREENGLASS HOUSE 18 FRANKS STREET LONDON SW1P 1JH
T: 020 7630 0500 F: 020 7630 9059 E: mail@darlingassociates.net

Project: 210 Pentonville Road

• London

Title:

• Door elevations - Resi

•

Project No:	Drawing No:	Revised:
• 6007	• (32)21	• E
Scale: 1/25 @ A1	1/50 @ A3	C&O File No: K:/6007/Current/End(32)
Date: 2007.10.11	Drawn: AP	Issued: MP