

All levels are in metres above Ordnance Datum.

All dimensions should be checked on site. Do not scale from this
drawing. Stanton Williams to be advised of any variation
between the drawings and site conditions.

To be read in conjunction with: architectural drawings and
specification, structural and services engineers information, and
fire / acoustic/ security strategies.

Safety, health and environmental information

Please refer to pre-construction information and risk register. The
notes below refer specifically to the information shown on this
drawing.



Description of Design Risk

Notes

Survey Note

1 This drawing has been prepared using recent survey information
where access has been possible. Large areas of the Poultry Market
remain tenanted and it has therefore not been possible to provide
survey information for these areas. Some assumed information has
been drawn from earlier survey and historic drawings where possible
but this remains unconfirmed.

2 The survey models provided by Plowman Craven are in Revit
version 2017. These have subsequently been upgraded to Revit 2018
by the Design Team for use in producing 2D drawings. Due to the
upgrade process, the Design Team accept no responsibility for the
accuracy / validation of the digital data supplied.

Drawing Notes

1 To be read in conjunction with: Fire strategy - 0021 series, Acoustic
strategy 0022 series, Security strategy - 0023 series, Layout plans - 0040
series, Internal walls - 22 series

2 Where setting out from existing elements, contractor to survey prior to
fabrication

3 Contractor to ensure that all performance requirements are met

Key

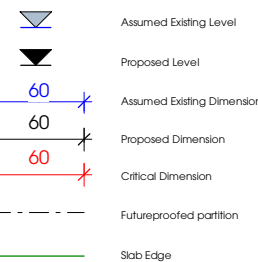

T01	09/03/2021	MW4.2 Issued for Tender
P01	02/02/2021	Draft 4.2 Issue
C01	18/03/2024	EWN123 - Issued for internal timber and metal doors

Revision	Date	Description
----------	------	-------------

Location

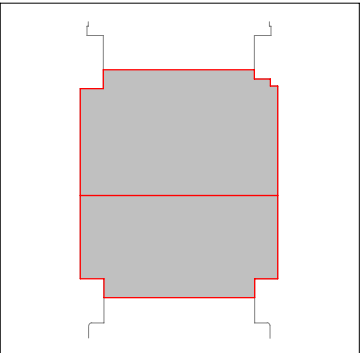

Stanton Williams
36 Graham Street
London N1 8GJ
Phone +44 (0)20 7880 6400
Email 2125@stantonwilliams.com
www.stantonwilliams.com

STANTON
WILLIAMS

Asif Khan

Asif Khan Ltd.
24-26 Richey Road
London E2 9AP
Phone +44(0)20 7729 3773
Email 2108@asifkhan.com
www.asifkhan.com

JULIAN HARRAP
ARCHITECTS LLP

Julian Harrap Architects LLP
95 Kingsland Road
London E2 8AG
Phone +44 (0)20 7729 8111
Email admin@julianharraparchitects.co.uk
www.julianharraparchitects.co.uk

Project

Museum of London

Drawing Title

PM - Internal Doors - Metal - Typical Details
DRM-07

Drawn	Checked	Approved	Status
TC	AH	AF	Stage 5

Date	Scale @ A3	Project No.	Revision
29/01/21	1 : 5	2125	C01

Drawing No. 32714

Project	Originator	Volume	Level	Type	Role	Number	Revision	Suitability
2125	SWA	PM	00	DR	A	32714	C01	S4

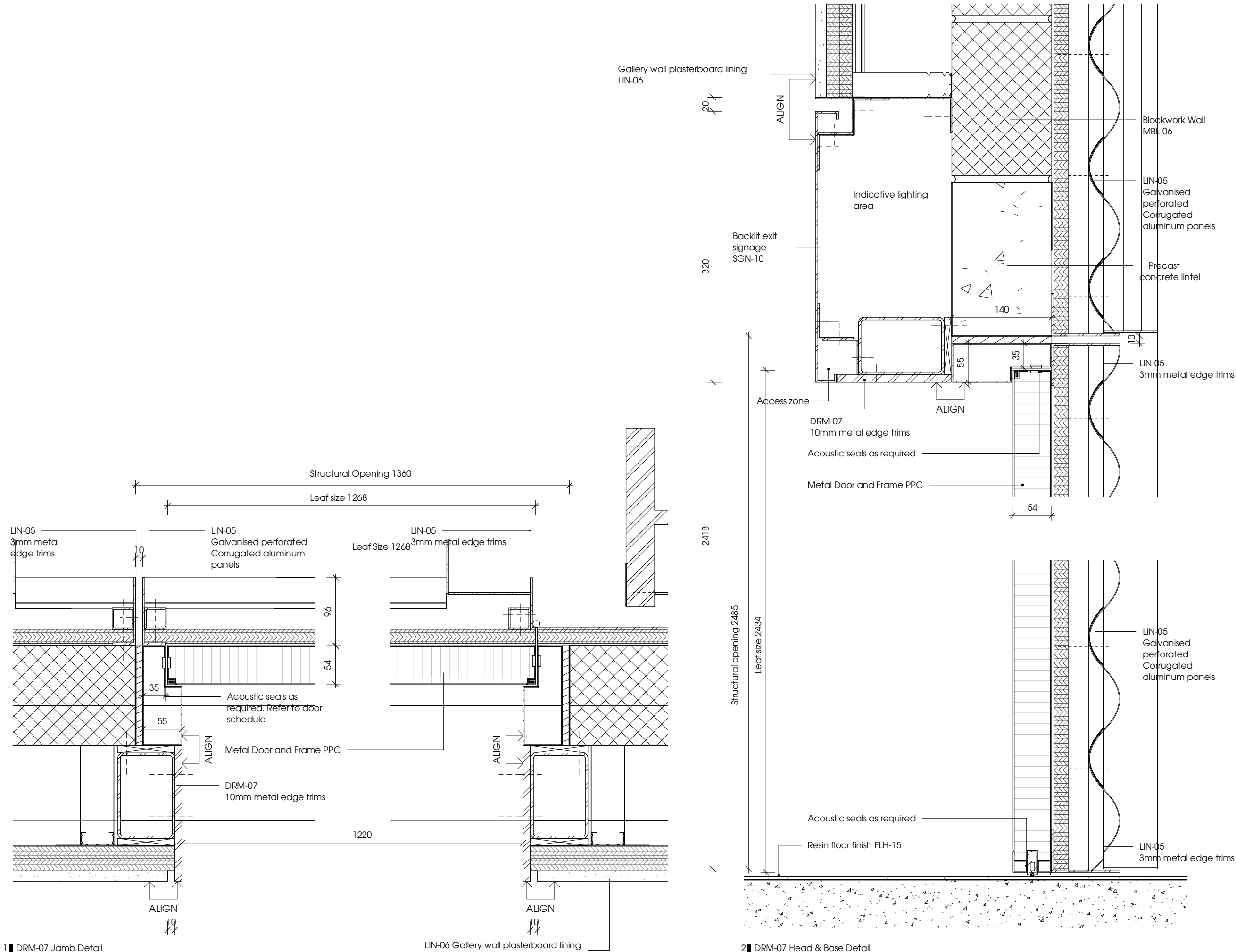

1 | DRM-07 Jamb Detail

LIN-06 Gallery wall plasterboard lining

2 | DRM-07 Head & Base Detail