

REV	DATE	DESCRIPTION
T01	09/03/20	STAGE 4 ISSUE
T02	13/03/20	STAGE 4 UPDATE ISSUE
T03	09/04/20	STAGE 4 ISSUE

CONSULTANTS	
CLIENT:	CROSSTREE REAL ESTATE PARTNERS LLP
STRUCTURAL ENGINEER:	HEYNE TILLET STIEL
MECHANICAL ENGINEER:	HURLEY PALMER FLATT
PROJECT MANAGER:	JACKSON COLES
COST CONSULTANT:	CORE FIVE LLP
HOTEL ARCHITECT:	DEXTER MOREN ASSOCIATES
SUSTAINABILITY CONSULTANT:	EIGHT ASSOCIATES
PLANNING CONSULTANT:	DP9
PROJECT MANAGER:	JACKSON COLES
ACOUSTIC CONSULTANT:	HANN TUCKER

NOTE

When this drawing is issued in uncontrolled CAD format it will be accompanied by a PDF version and is issued to enable the recipient to prepare their own documents / drawings for use. The drawings are solely representative of the information provided. The recipient shall not rely on the drawings for any dimensions and discrepancies to the architect. All dimensions should be checked on site by the contractor and such dimensions shall be the contractor's responsibility.

Alford Hall Monaghan Morris Limited accepts no responsibility or liability for any use of this drawing by parties other than the party for whom it was prepared or for purposes other than those for which it was prepared. It is not intended that any alterations or additions to or discrepancies arising out of changes to the background information on which the drawings are based that was current at the time the drawings were prepared will be reflected in the drawings. It is not intended that any loss or degradation of the information held in this drawing resulting from the transfer from the original file format to any other file format or from the recipient's use of the drawings will be reflected in the drawings. It is not intended that the reading of it in any other programme or any version of the programme other than the one in which it was prepared will be reflected in the drawings. It is not intended that the accuracy of survey information provided by others or for any costs, claims, proceedings and expenses arising out of reliance on such information for scaling or for any other purpose in the planning application is solely for the purposes of the planning application to which it relates.

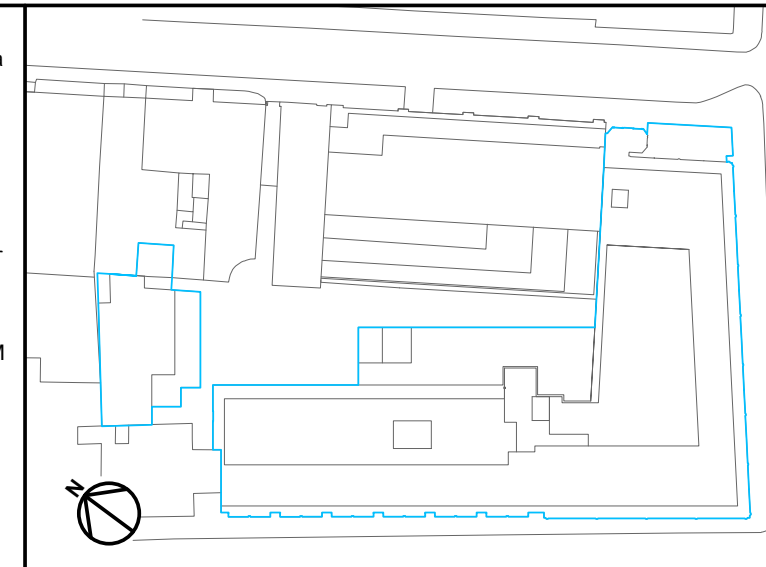

ALLFORD HALL MONAGHAN MORRIS ARCHITECTS Ltd MORELANDS, 5-23 OLD STREET LONDON EC1V 9HL TEL 020 7251 5261 FAX 020 7251 5123 WEB WWW.AHMM.CO.UK						
job title <div style="border: 1px solid black; padding: 5px; text-align: center;"> BERKELEY STREET </div>						
drawing title / location <div style="border: 1px solid black; padding: 5px; text-align: center;"> EXTERNAL ENVELOPE SCOPE - THIRD FLOOR PLAN </div>						
drawn by <div style="border: 1px solid black; padding: 2px; text-align: center;"> MH </div>	checked <div style="border: 1px solid black; padding: 2px; text-align: center;"> BB </div>	scale <div style="border: 1px solid black; padding: 2px; text-align: center;"> As indicated@A1 </div>			status <div style="border: 1px solid black; padding: 2px; text-align: center;"> TENDER </div>	
project <div style="border: 1px solid black; padding: 10px; text-align: center;"> 16014 </div>		zone <div style="border: 1px solid black; padding: 10px; text-align: center;"> A </div>	source <div style="border: 1px solid black; padding: 10px; text-align: center;"> (21) </div>	classification <div style="border: 1px solid black; padding: 10px; text-align: center;"> _103 </div>	drawing no. <div style="border: 1px solid black; padding: 10px; text-align: center;"> T03 </div>	