

KEY		For Fire Ratings Refer to (06) Series	For Architectural Linings Refer to (42) series
FIXED PARTITION SYSTEM	FPS-100	145mm Gyp/Wall Staggered w/ Moisture Resistant Lining	min FR 90mins min AR 53dB
	FPS-101	414mm BG Gyp Quiet w/ Moisture Resistant Lining	min FR 90mins min AR 53dB
	FPS-102	122mm Gyp/Wall Robust	min FR 120mins min AR 60dB
	FPS-103	162mm Gyp/Wall Quiet SF	min FR 90mins min AR 65dB
SHAFTWALL SYSTEMS	IWS-100	92mm Shaft/Wall w/ FireLine Lining	min FR 90mins min AR 50dB
	IWS-101	107mm Shaft/Wall w/ FireLine Lining	min FR 120mins min AR 50dB
WALL FINISHES	IWS-110	FineLine Plasterboard Lining	min FR 60mins min AR 0dB
	IWS-111	Moisture Resistant Plasterboard Lining	min FR 0mins min AR 0dB
BLOCKWORK SYSTEMS	BLK-200	100mm High Density Concrete Block	min FR 120mins min AR 55dB
	BLK-201	100mm Architectural Blockwork	min FR 120mins min AR 50dB
WATER PROOFING SYSTEMS	WPS-100	15mm Sika 1 Render	min FR 0mins min AR 0dB
	STRUCTURE & UKPN	New Structural Elements Refer to Structural Engineer's Drawings	
	UKPN Substation Walls Refer to UKPN & Mechanical Engineer's Specification		

REV	DATE	DESCRIPTION
T01	09/03/20	STAGE 4 ISSUE
T02	09/04/20	STAGE 4 ISSUE

CONSULTANTS	
CLIENT:	CROSSTREE REAL ESTATE PARTNERS LLP
STRUCTURAL ENGINEER:	HEYNE TILLET STEEL
MECHANICAL ENGINEER:	HURLEY PALMER FLATT
PROJECT MANAGER:	JACKSON COLES
COST CONSULTANT:	CORE FIVE LLP
HOTEL ARCHITECT:	DEXTER MOREN ASSOCIATES
SUSTAINABILITY CONSULTANT:	EIGHT ASSOCIATES
PLANNING CONSULTANT:	DP9
PROJECT MANAGER:	JACKSON COLES
ACOUSTIC CONSULTANT:	HANN TUCKER

NOTE

When this drawing is issued in uncontrolled CAD format it will be accompanied by a PDF version and is issued to enable the recipient to prepare their own documents / models / drawings for which they are solely responsible. The recipient should report all drawing errors, omissions and discrepancies to the architect. All dimensions should be checked on site by the contractor and such dimensions shall be the contractor's responsibility.

Allford Hall Monaghan Morris Limited accepts no responsibility or liability for:-

- any use of this drawing by parties other than the party for whom it was prepared or for purposes other than those for which it was prepared
- any alterations or additions to or discrepancies arising out of changes to the background information on which the drawings are based that was current at the time of issue, and which occur to that information after it has been issued by AHMM
- any loss or degradation of the information held in this drawing resulting from the translation from the original file format to any other file format or from the recipient's reading of it in any other programme or any version of the programme other than that which was used to prepare it
- the accuracy of survey information provided by others or for any costs, claims, proceedings and expenses arising out of reliance on such information
- any scaling from this drawing other than by the local planning authority solely for the purposes of the planning application to which it relates

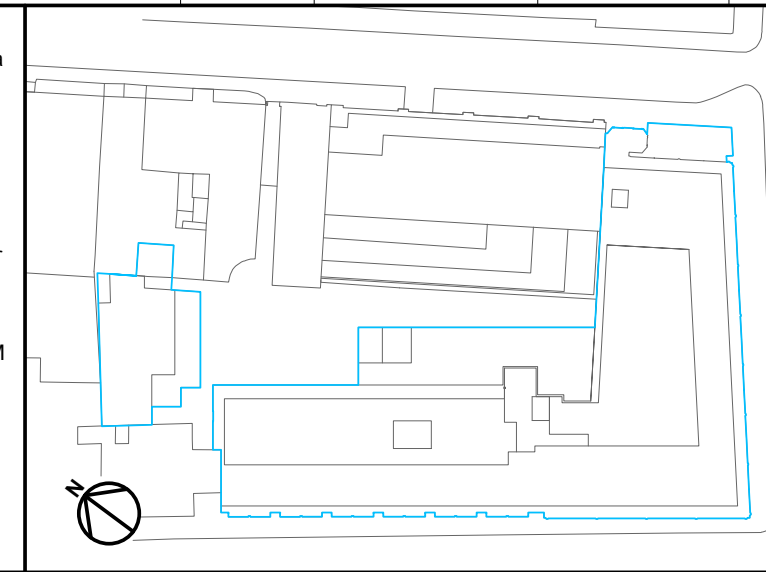

ALLFORD HALL MONAGHAN MORRIS
ARCHITECTS LTD
MORELANDS, 5-23 OLD STREET LONDON EC1V 9HL
TEL 020 7251 5261 FAX 020 7251 5123 WEB WWW.AHMM.CO.UK

job title
BERKELEY STREET

drawing title / location
**INTERNAL WALLS - SEVENTH FLOOR
SCOPING PLAN**

drawn by	checked	scale	status
OU	BB	1 : 125@A1	TENDER
project	zone	source/ classification	drawing no. revision
16014		A (22)_107	T02