

KEY		For Fire Ratings Refer to (06) Series	For Architectural Linings Refer to (42) series
FIXED PARTITION SYSTEM	FPS-100	145mm Gyp/Wall Staggered w/ Moisture Resistant Lining	m FR 90mins m AR 53x8
	FPS-101	414mm BG Gyp Quiet w/ Moisture Resistant Lining	m FR 90mins m AR 53x8
	FPS-102	122mm Gyp/Wall Robust	m FR 120mins m AR 0db
	FPS-103	162mm Gyp/Wall Quiet SF	m FR 90mins m AR 65x8
SHAFTWALL SYSTEMS	IWS-100	92mm Shaft/Wall w/ FireLine Lining	m FR 90mins m AR 50x8
	IWS-101	107mm Shaft/Wall w/ FireLine Lining	m FR 120mins m AR 50x8
WALL FINISHES	IWS-110	Fireline Plasterboard Lining	m FR 60mins m AR 0db
	IWS-111	Moisture Resistant Plasterboard Lining	m FR 0mins m AR 0db
BLOCKWORK SYSTEMS	BLK-200	100mm High Density Concrete Block	m FR 120mins m AR 55x8
	BLK-201	100mm Architectural Blockwork	m FR 120mins m AR 50x8
WATER PROOFING SYSTEMS		WPS-100	15mm Sika 1 Render
STRUCTURE & UKPN		New Structural Elements Refer to Structural Engineer's Drawings	
		UKPN Substation Walls Refer to UKPN & Mechanical Engineer's Specification	

REV	DATE	DESCRIPTION
T01	09/03/20	STAGE 4 ISSUE
T02	09/04/20	STAGE 4 ISSUE

CONSULTANTS	
CLIENT:	CROSSTREE REAL ESTATE PARTNERS LLP
STRUCTURAL ENGINEER:	HEYNE TILLET STEEL
MECHANICAL ENGINEER:	HURLEY PALMER FLATT
PROJECT MANAGER:	JACKSON COLES
COST CONSULTANT:	CORE FIVE LLP
HOTEL ARCHITECT:	DEXTER MOREN ASSOCIATES
SUSTAINABILITY CONSULTANT:	EIGHT ASSOCIATES
PLANNING CONSULTANT:	DP9
PROJECT MANAGER:	JACKSON COLES
ACOUSTIC CONSULTANT:	HANN TUCKER

NOTE	
When this drawing is issued in uncontrolled CAD format it will be accompanied by a PDF version and is issued to enable the recipient to prepare their own documents / models / drawings for which they are solely responsible. The recipient should report all drawing errors, omissions and discrepancies to the architect. All dimensions should be checked on site by the contractor and such dimensions shall be the contractor's responsibility.	
Allford Hall Monaghan Morris Limited accepts no responsibility or liability for:- - any use of this drawing by parties other than the party for whom it was prepared or for purposes other than those for which it was prepared - any alterations or additions to or discrepancies arising out of changes to the background information on which the drawings are based that was current at the time of issue, and which occur to that information after it has been issued by AHMM - any loss or degradation of the information held in this drawing resulting from the translation from the original file format to any other file format or from the recipient's reading of it in any other programme or any version of the programme other than that which was used to prepare it - the accuracy of survey information provided by others or for any costs, claims, proceedings and expenses arising out of reliance on such information - any scaling from this drawing other than by the local planning authority solely for the purposes of the planning application to which it relates	

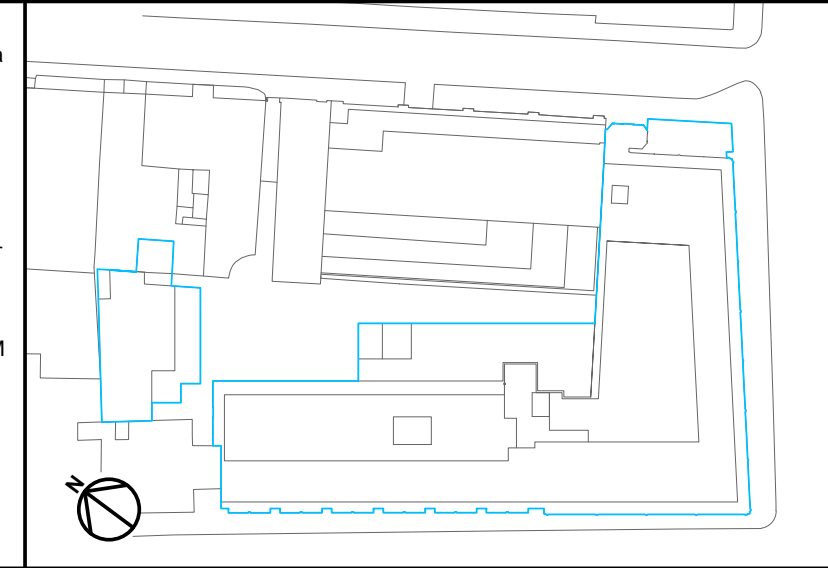

ALLFORD HALL MONAGHAN MORRIS					
ARCHITECTS LTD MORELANDS, 5-23 OLD STREET LONDON EC1V 9HL TEL 020 7251 6261 FAX 020 7251 5123 WEB WWW.AHMM.CO.UK					
job title BERKELEY STREET					
drawing title / location INTERNAL WALLS - NINTH FLOOR SCOPING PLAN					
drawn by OU	checked BB	scale 1 : 125@A1	status TENDER		
project 16014	zone	source A	classification (22)_109	drawing no. T02	revision