

| REV | DATE | DESCRIPTION |
|-----|----------|---------------|
| T01 | 09/03/20 | STAGE 4 ISSUE |
| T02 | 09/04/20 | STAGE 4 ISSUE |

| CONSULTANTS | |
|----------------------------|------------------------------------|
| CLIENT: | CROSSTREE REAL ESTATE PARTNERS LLP |
| STRUCTURAL ENGINEER: | HEYNE TILLET STIEL |
| MECHANICAL ENGINEER: | HURLEY PALMER FLATT |
| PROJECT MANAGER: | JACKSON COLES |
| COST CONSULTANT: | CORE FIVE LLP |
| HOTEL ARCHITECT: | DEXTER MOREN ASSOCIATES |
| SUSTAINABILITY CONSULTANT: | EIGHT ASSOCIATES |
| PLANNING CONSULTANT: | DP9 |
| PROJECT MANAGER: | JACKSON COLES |
| ACOUSTIC CONSULTANT: | HANN TUCKER |
| | |

NOTE

When this drawing is issued in uncontrolled CAD format it will be accompanied by a PDF version and it is issued to enable the recipient to prepare their own documents / drawings. Drawings for which they are solely responsible.

The recipient should accept all drawings as they are, dimensions and discrepancies to the architect. All dimensions should be checked on site by the contractor and such dimensions shall be the contractor's responsibility.

Allford Hall Monaghan Morris Limited accepts no responsibility or liability for any use of this drawing by parties other than the party for whom it was prepared or for purposes other than those for which it was prepared.

any alterations or additions to or discrepancies arising out of changes to the background information on which the drawings are based that was current at the time the drawings were prepared. If it is later seen in the drawings that there is any loss or degradation of the information held in this drawing resulting from the translation from the original file format to any other file format or from the recipients use of the original programme or any version of the programme other than that which was used to produce it.

the accuracy of survey information provided by others or for any costs, claims, proceedings and expenses arising out of reliance on such information

the accuracy of the information used in the planning application solely for the purposes of the planning application to which it relates

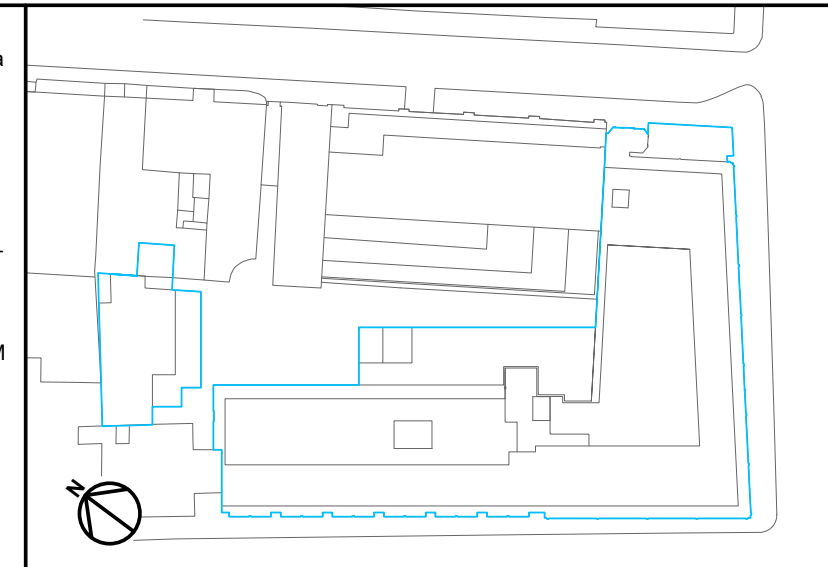

| | | | | | | |
|---|---------|------------|--------|----------------|-------------|----------|
| ALLFORD HALL MONAGHAN MORRIS ARCHITECTS LTD MORELANDS, 5-23 OLD STREET LONDON EC1V 9HL TEL 020 7521 5261 FAX 020 7521 5123 WEB WWW.AHMM.CO.UK | | | | | | |
| job title | | | | | | |
| BERKELEY STREET | | | | | | |
| drawing title / location | | | | | | |
| FLOOR SCOPING PLAN - SEVENTH FLOOR | | | | | | |
| drawn by | checked | scale | | | status | |
| SB | BB | 1 : 125@A1 | | | TENDER | |
| project | | zone | source | classification | drawing no. | revision |
| 16014 | | | A | (23)_ | 107 | T02 |