



KEY		
NOTE:		
1. Door drawings should be read in conjunction with (22) series drawings for wall types.		
2. Door drawings should be read in conjunction with door schedule (32)_900 series.		
3. Refer to Fire drawings (08) series and fire strategy report for verification of the fire ratings of doors and adjacent construction.		
4. Refer to Security Consultant Fluent 2 information for security and access control requirements.		
5. Refer to Acoustic Consultant for verification of acoustic ratings to doors and adjacent construction.		
6. For external doorsets refer to (21) series.		
7. Ironmongery shown is indicative. Refer to Door Schedule 32_(910) for ironmongery sets.		

REV	DATE	DESCRIPTION
T01	09/03/20	STAGE 4 ISSUE

CONSULTANTS	
CLIENT:	CROSSTREE REAL ESTATE PARTNERS LLP
STRUCTURAL ENGINEER:	HEYNE TILLET STIEL
MECHANICAL ENGINEER:	HURLEY PALMER FLATT
PROJECT MANAGER:	JACKSON COLES
COST CONSULTANT:	CORE FIVE LLP
HOTEL ARCHITECT:	DEXTER MOREN ASSOCIATES
SUSTAINABILITY CONSULTANT:	EIGHT ASSOCIATES
PLANNING CONSULTANT:	DP9
PROJECT MANAGER:	JACKSON COLES
ACOUSTIC CONSULTANT:	HANN TUCKER

NOTE	
When this drawing is issued in uncontrolled CAD format it will be accompanied by a PDF version and is issued to enable the recipient to prepare their own documents / models / drawings for which they are solely responsible.	
The recipient should report all drawing errors, omissions and discrepancies to the architect. All dimensions should be checked on site by the contractor and such dimensions shall be the contractor's responsibility.	
Allford Hall Monaghan Morris Limited accepts no responsibility or liability for:-	
- any use of this drawing by parties other than the party for whom it was prepared or for purposes other than those for which it was prepared	
- any alterations or additions to or discrepancies arising out of changes to the background information on which the drawings are based that was current at the time of issue, and which occur to that information after it has been issued by AHMM	
- any loss or degradation of the information held in this drawing resulting from the translation from the original file format to any other file format or from the recipient's reading of it in any other programme or any version of the programme other than that which was used to prepare it	
- the accuracy of survey information provided by others or for any costs, claims, proceedings and expenses arising out of reliance on such information	
- any scaling from this drawing other than by the local planning authority solely for the purposes of the planning application to which it relates	

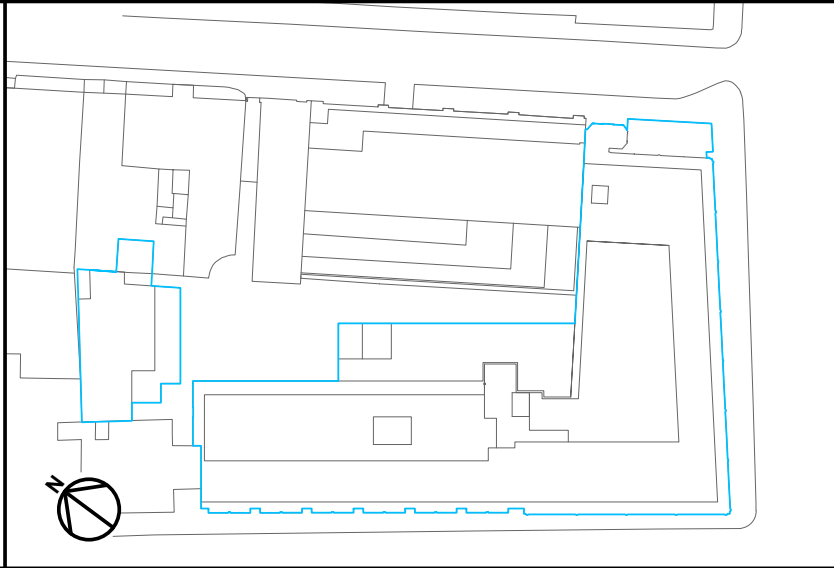

ALLFORD HALL MONAGHAN MORRIS					
ARCHITECTS LTD MORELANDS, 5-23 OLD STREET LONDON EC1V 9HL TEL 020 7251 6261 FAX 020 7251 5123 WEB WWW.AHMM.CO.UK					
job title					
BERKELEY STREET					
drawing title / location					
INTERNAL DOORS SCOPING PLAN - FIFTH FLOOR					
drawn by	checked	scale	status		
YK	BB	1 : 125@A1	TENDER		
project	zone	source	classification	drawing no.	revision
16014		A	(32)_105	T01	