

**KEY**  
**WALLS/ CURTAINS**  
240 Min Wall  
120 Min Wall  
90 Min Wall  
60 Min Wall  
30 Min Wall  
60 Min Fire/ Smoke Curtain  
90 Min Fire/ Smoke Curtain  
120 Min Fire/ Smoke Curtain

**DOORS**  
FD 30 Door  
FD 60 Door  
FD 90 Door  
FD 30S Door  
FD 60S Door

**OTHER**  
Dry Riser Locations  
Raked Ladder & Fixed Hatch  
Sprinklers

Accessible Refuge Zone  
  
Fire Fighting Shaft  
  
Fire Control Panel  
  
Means of Escape

FD 90S Door  
  
UKPN Spec Sunray Blastproof Door

REV	DATE	DESCRIPTION	NOTE
T01	09/03/20	STAGE 4 ISSUE	
T02	31/03/20	ISSUE FOR INFORMATION	
T03	03/04/20	ISSUE FOR INFORMATION	
T04	09/04/20	STAGE 4 ISSUE	

**Notes:**  
1. See M&E engineer's information for details.  
2. Hotel fit out walls by others, to be coordinated.  
3. Hotel fit-out team to ensure fire performance as per fire strategy.

CONSULTANTS	
CLIENT:	CROSSTREE REAL ESTATE PARTNERS LLP
STRUCTURAL ENGINEER:	HEYNE TILLET STEEL
MECHANICAL ENGINEER:	HURLEY PALMER FLATT
PROJECT MANAGER:	JACKSON COLES
COST CONSULTANT:	CORE FIVE LLP
HOTEL ARCHITECT:	DEXTER MOREN ASSOCIATES
SUSTAINABILITY CONSULTANT:	EIGHT ASSOCIATES
PLANNING CONSULTANT:	DP9
PROJECT MANAGER:	JACKSON COLES
ACOUSTIC CONSULTANT:	HANN TUCKER

**NOTE**

When this drawing is issued in uncontrolled CAD format it will be accompanied by a PDF version and is issued to enable the recipient to prepare their own documents / models / drawings for which they are solely responsible.

The recipient should report all drawing errors, omissions and discrepancies to the architect. All dimensions should be checked on site by the contractor and such dimensions shall be the contractor's responsibility.

Allford Hall Monaghan Morris Limited accepts no responsibility or liability for:-

- any use of this drawing by parties other than the party for whom it was prepared or for purposes other than those for which it was prepared
- any alterations or additions to or discrepancies arising out of changes to the background information on which the drawings are based that was current at the time of issue, and which occur to that information after it has been issued by AHMM
- any loss or degradation of the information held in this drawing resulting from the translation from the original file format to any other file format or from the recipient's reading of it in any other programme or any version of the programme other than that which was used to prepare it
- the accuracy of survey information provided by others or for any costs, claims, proceedings and expenses arising out of reliance on such information
- any scaling from this drawing other than by the local planning authority solely for the purposes of the planning application to which it relates

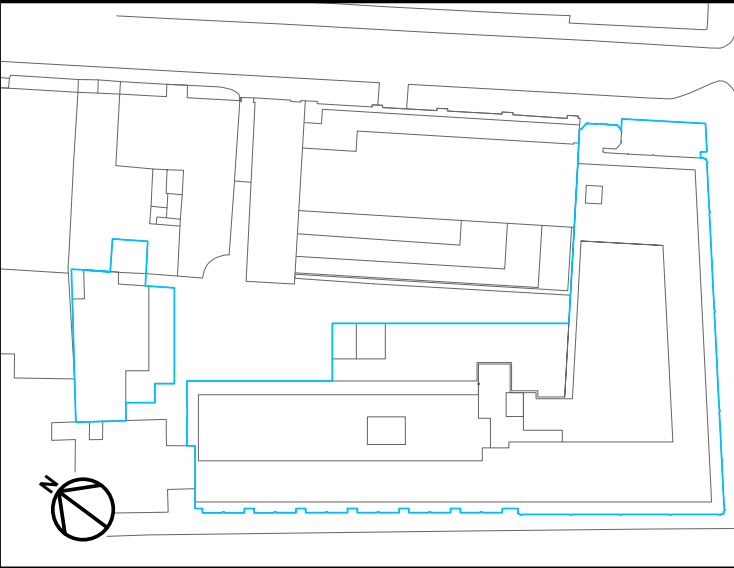

**ALLFORD HALL MONAGHAN MORRIS**  
ARCHITECTS LTD  
MORELANDS, 5-23 OLD STREET LONDON EC1V 9HL  
TEL 020 7251 6261 FAX 020 7251 5123 WEB WWW.AHMM.CO.UK  
job title

**BERKELEY STREET**  
drawing title / location  
**FIRE STRATEGY PLAN - SECOND FLOOR**

drawn by	checked	scale	status
OU	BB	As indicated@A1	TENDER
project	zone	source/ classification	drawing no. revision
16014		A (68)_102	T04