

| KEY             |                             | DOORS |             | OTHER |                            |
|-----------------|-----------------------------|-------|-------------|-------|----------------------------|
| WALLS/ CURTAINS |                             |       |             |       |                            |
|                 | 240 Min Wall                |       | FD 30 Door  |       | Dry Riser Locations        |
|                 | 120 Min Wall                |       | FD 60 Door  |       | Raked Ladder & Fixed Hatch |
|                 | 90 Min Wall                 |       | FD 90 Door  |       | Sprinklers                 |
|                 | 60 Min Wall                 |       | FD 30S Door |       |                            |
|                 | 30 Min Fire/ Smoke Curtain  |       | FD 60S Door |       |                            |
|                 | 60 Min Fire/ Smoke Curtain  |       |             |       |                            |
|                 | 90 Min Fire/ Smoke Curtain  |       |             |       |                            |
|                 | 120 Min Fire/ Smoke Curtain |       |             |       |                            |

| REV | DATE     | DESCRIPTION           | NOTE |
|-----|----------|-----------------------|------|
| T01 | 09/03/20 | STAGE 4 ISSUE         |      |
| T02 | 31/03/20 | ISSUE FOR INFORMATION |      |
| T03 | 03/04/20 | ISSUE FOR INFORMATION |      |
| T04 | 09/04/20 | STAGE 4 ISSUE         |      |

**Notes:**

- See M&E engineer's information for details.
- Hotel fit out walls by others, to be coordinated.
- Hotel fit-out team to ensure fire performance as per fire strategy.

| CONSULTANTS                |                                    |
|----------------------------|------------------------------------|
| CLIENT:                    | CROSSTREE REAL ESTATE PARTNERS LLP |
| STRUCTURAL ENGINEER:       | HEYNE TILLET STEEL                 |
| MECHANICAL ENGINEER:       | HURLEY PALMER FLATT                |
| PROJECT MANAGER:           | JACKSON COLES                      |
| COST CONSULTANT:           | CORE FIVE LLP                      |
| HOTEL ARCHITECT:           | DEXTER MOREN ASSOCIATES            |
| SUSTAINABILITY CONSULTANT: | EIGHT ASSOCIATES                   |
| PLANNING CONSULTANT:       | DP9                                |
| PROJECT MANAGER:           | JACKSON COLES                      |
| ACOUSTIC CONSULTANT:       | HANN TUCKER                        |

**NOTE**

When this drawing is issued in uncontrolled CAD format it will be accompanied by a PDF version and is issued to enable the recipient to prepare their own documents / models / drawings for which they are solely responsible.

The recipient should report all drawing errors, omissions and discrepancies to the architect. All dimensions should be checked on site by the contractor and such dimensions shall be the contractor's responsibility.

Allford Hall Monaghan Morris Limited accepts no responsibility or liability for:-

- any use of this drawing by parties other than the party for whom it was prepared or for purposes other than those for which it was prepared
- any alterations or additions to or discrepancies arising out of changes to the background information on which the drawings are based that was current at the time of issue, and which occur to that information after it has been issued by AHMM
- any loss or degradation of the information held in this drawing resulting from the translation from the original file format to any other file format or from the recipient's reading of it in any other programme or any version of the programme other than that which was used to prepare it
- the accuracy of survey information provided by others or for any costs, claims, proceedings and expenses arising out of reliance on such information
- any scaling from this drawing other than by the local planning authority solely for the purposes of the planning application to which it relates

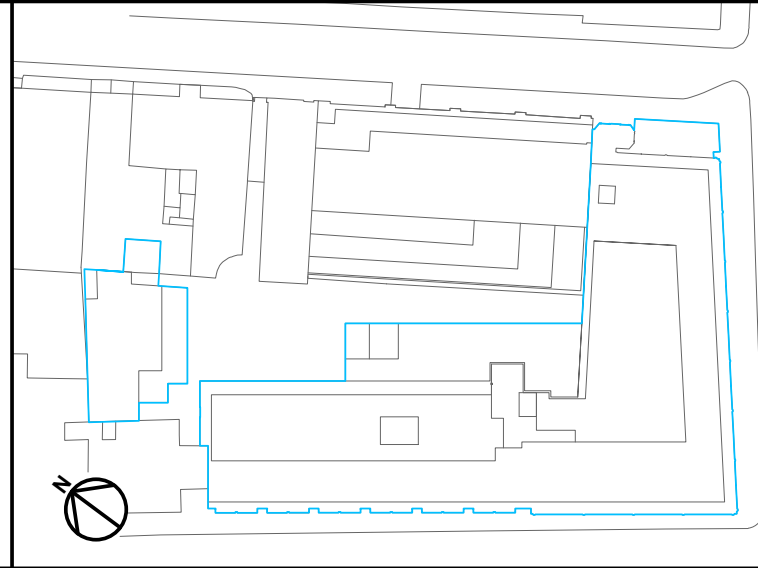

| ALLFORD HALL MONAGHAN MORRIS   |         |                 |                |             |          |
|--|---------|-----------------|----------------|-------------|----------|
| ARCHITECTS LTD<br>MORELANDS, 5-23 OLD STREET LONDON EC1V 9HL<br>TEL 020 7251 5261 FAX 020 7251 5123 WEB WWW.AHMM.CO.UK |         |                 |                |             |          |
| job title  |         |                 |                |             |          |
| BERKELEY STREET  |         |                 |                |             |          |
| drawing title / location   |         |                 |                |             |          |
| FIRE STRATEGY PLAN - FOURTH FLOOR  |         |                 |                |             |          |
| drawn by   | checked | scale           | status         |             |          |
| OU   | BB      | As indicated@A1 | TENDER         |             |          |
| project  | zone    | source          | classification | drawing no. | revision |
| 16014  |         | A               | (68)_104       | T04         |          |