

1 CORE C MALE WC ELEVATION 01 1 : 20

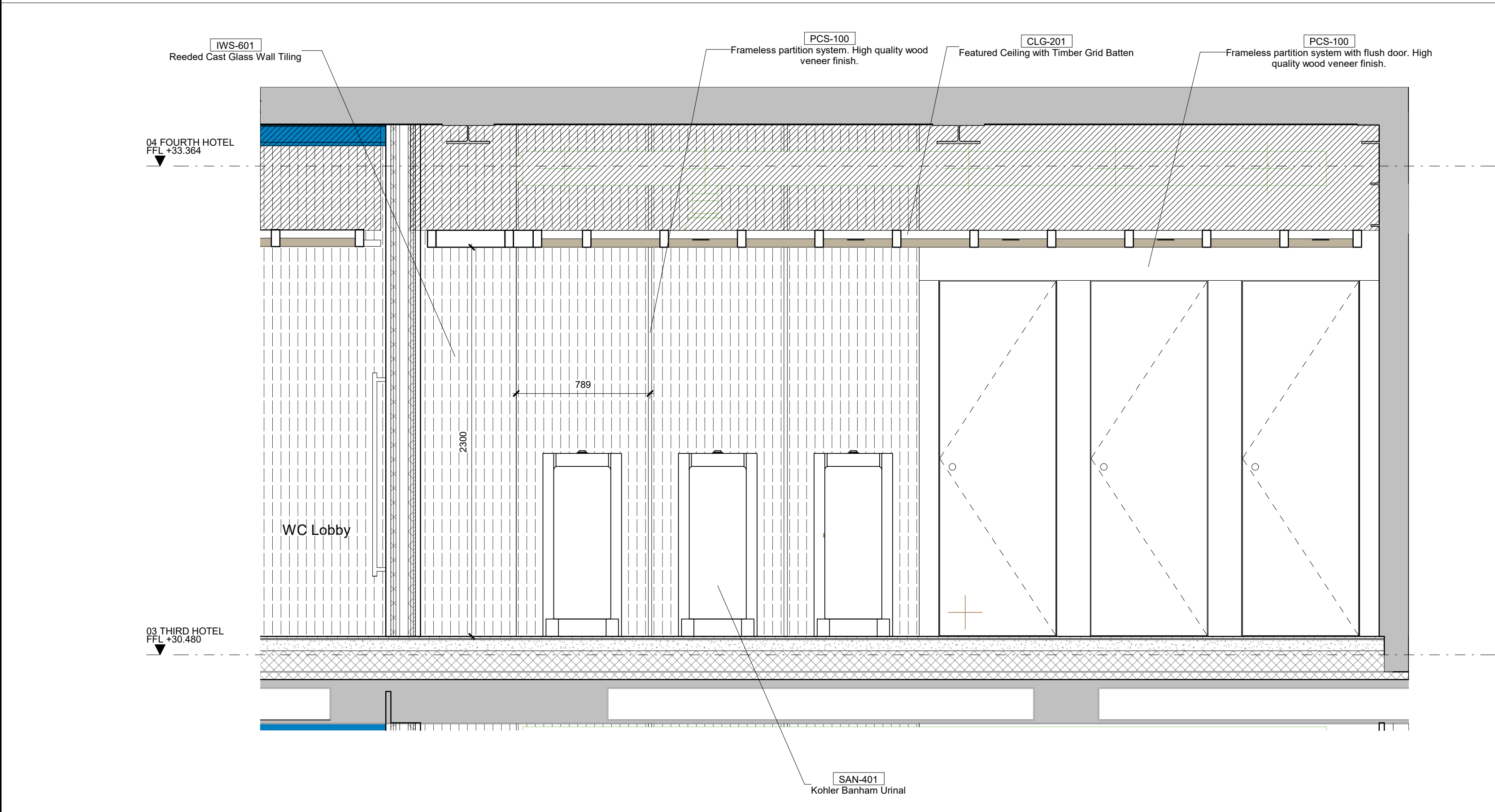

3 CORE C MALE WC ELEVATION 03 1 : 20

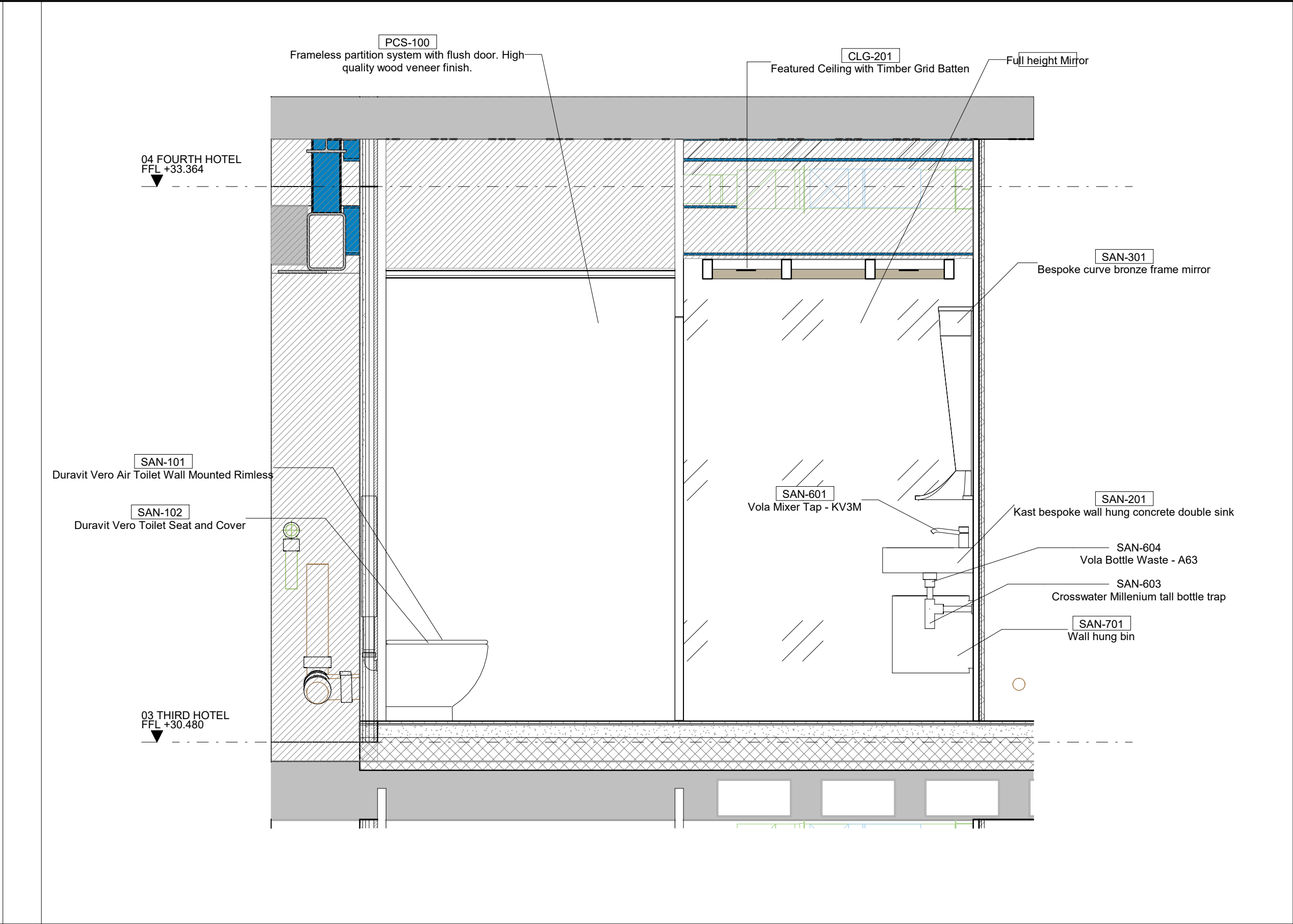

2 CORE C MALE WC ELEVATION 02 1 : 20

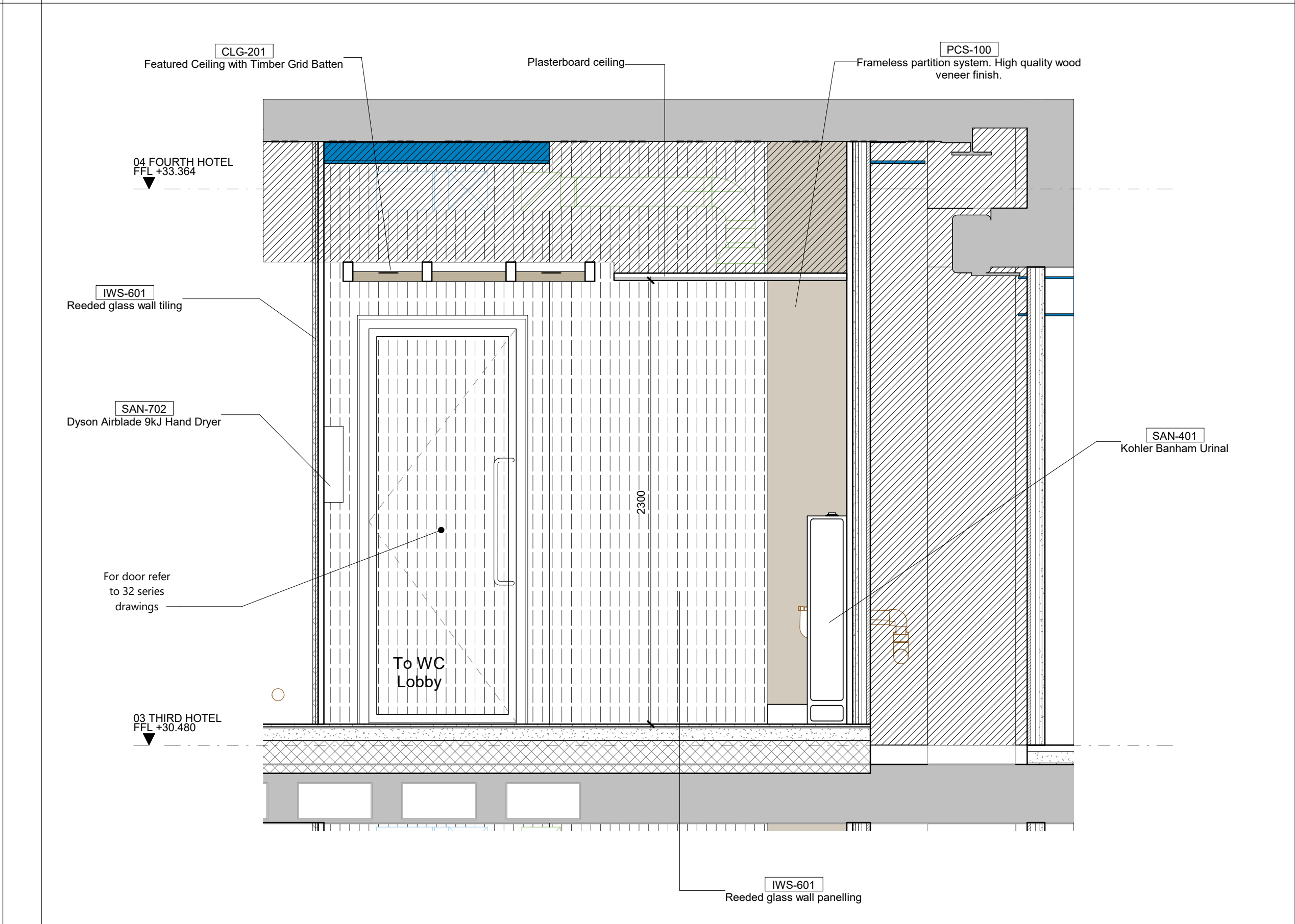

4 CORE C MALE WC ELEVATION 04 1 : 20

KEY		REV		DATE		DESCRIPTION		CONSULTANTS		NOTE		ALLFORD HALL MONAGHAN MORRIS	
		T01		09/03/20		STAGE 4 ISSUE		CLIENT: CROSSTREE REAL ESTATE PARTNERS LLP		When this drawing is issued in uncontrolled CAD format it will be accompanied by a PDF version and is issued to enable the recipient to prepare their own documents / models / drawings for which they are solely responsible. The recipient should report all drawing errors, omissions and discrepancies to the architect. All dimensions should be checked on site by the contractor and such dimensions shall be the contractor's responsibility.		ARCHITECTS Ltd MORELANDS, 5-23 OLD STREET LONDON EC1V 9HL TEL 020 7251 6261 FAX 020 7251 5123 WEB WWW.AHMM.CO.UK	
								STRUCTURAL ENGINEER: HEYNE TILLET STEEL		Alford Hall Monaghan Morris Limited accepts no responsibility or liability for:- any use of this drawing by parties other than the party for whom it was prepared or for purposes other than those for which it was prepared		JOB TITLE	
								MECHANICAL ENGINEER: HURLEY PALMER FLATT		- any alterations or additions to or discrepancies arising out of changes to the background information on which the drawings are based that was current at the time of issue, and which occur to that information after it has been issued by AHMM		DRAWING TITLE / LOCATION	
								PROJECT MANAGER: JACKSON COLES		- any loss or degradation of the information held in this drawing resulting from the translation from the original file format to any other file format or from the recipient's reading of it in any other programme or any version of the programme other than that which was used to prepare it		PROPOSED OFFICE CORE C MALE WC - ELEVATIONS	
								COST CONSULTANT: CORE FIVE LLP		- the accuracy of survey information provided by others or for any costs, claims, proceedings and expenses arising out of reliance on such information		DRAWN BY	
								HOTEL ARCHITECT: DEXTER MOREN ASSOCIATES		- any scaling from this drawing other than by the local planning authority solely for the purposes of the planning application to which it relates		CHECKED BY	
								SUSTAINABILITY CONSULTANT: EIGHT ASSOCIATES				SCALE	
								PLANNING CONSULTANT: DP9				1 : 20@A1	
								PROJECT MANAGER: JACKSON COLES				STATUS	
								ACOUSTIC CONSULTANT: HANN TUCKER				TENDER	
												PROJECT	
												16014	
												ZONE	
												SOURCE	
												A	
												(74)_283	
												T01	