

1 Proposed Accessible Toilet - Layout
Scale: 1:25

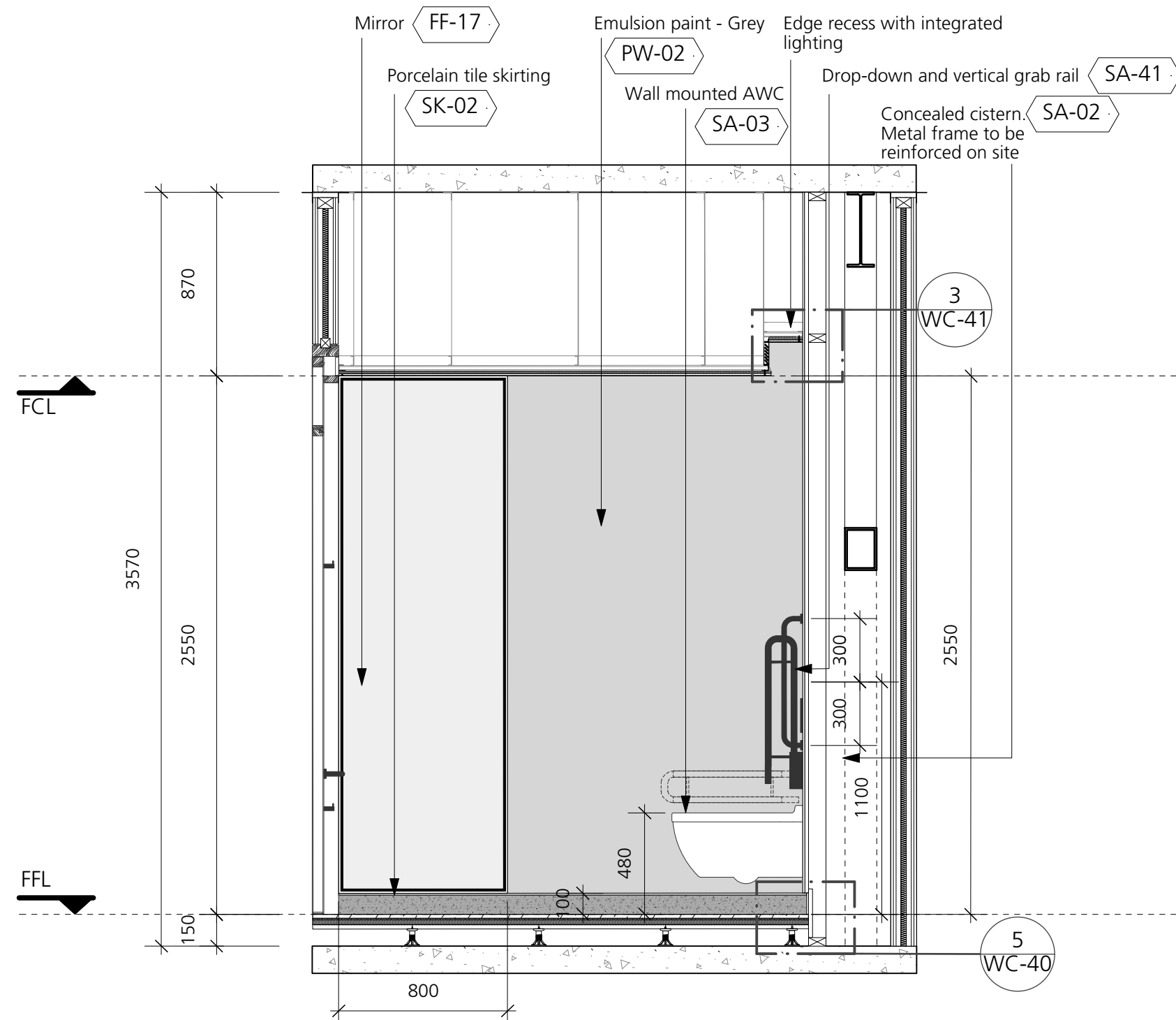

3 Proposed Accessible Toilet - Internal Elevation AA
Scale: 1:25

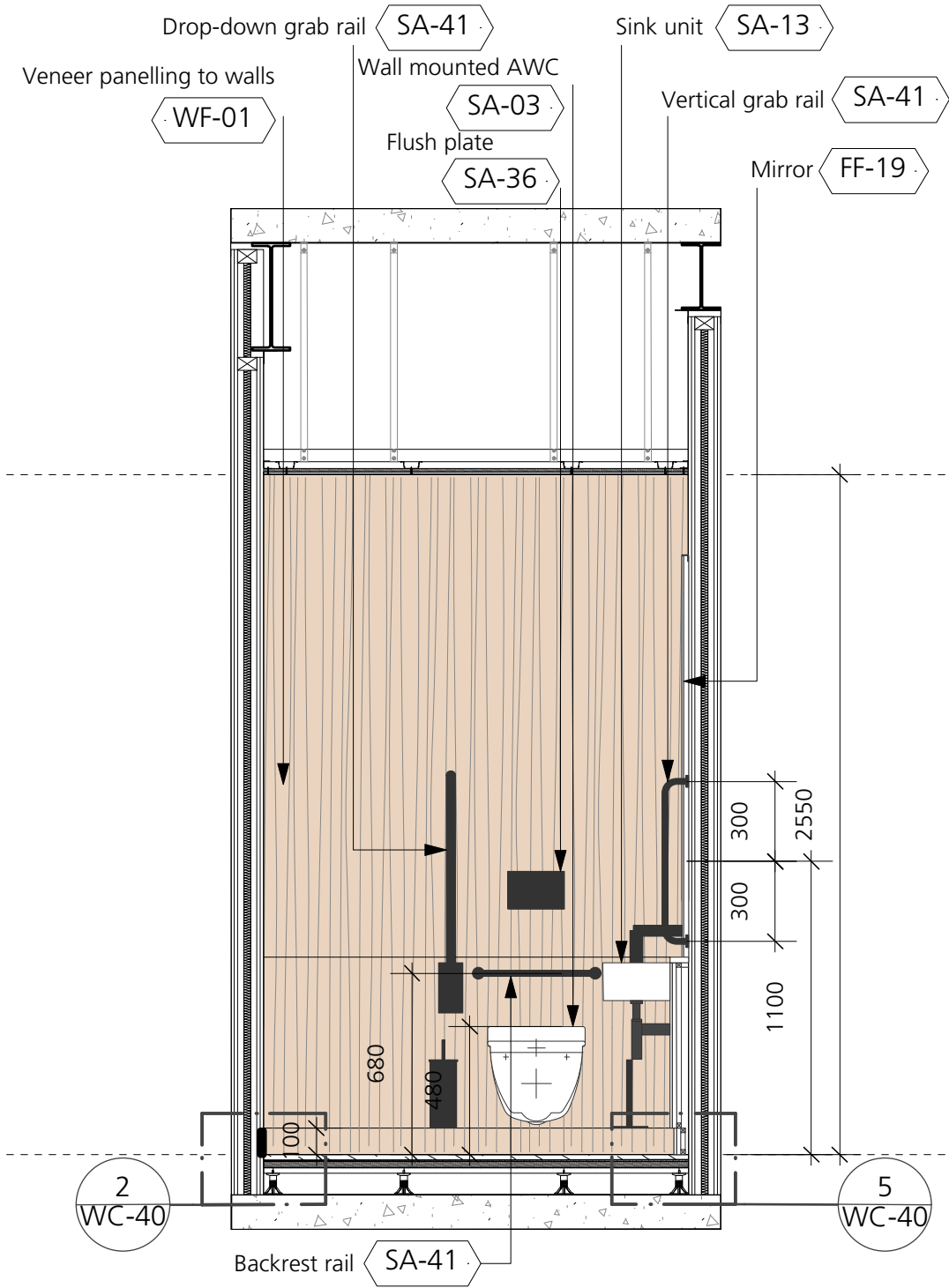

4 Proposed Accessible Toilet - Internal Elevation BB
Scale: 1:25

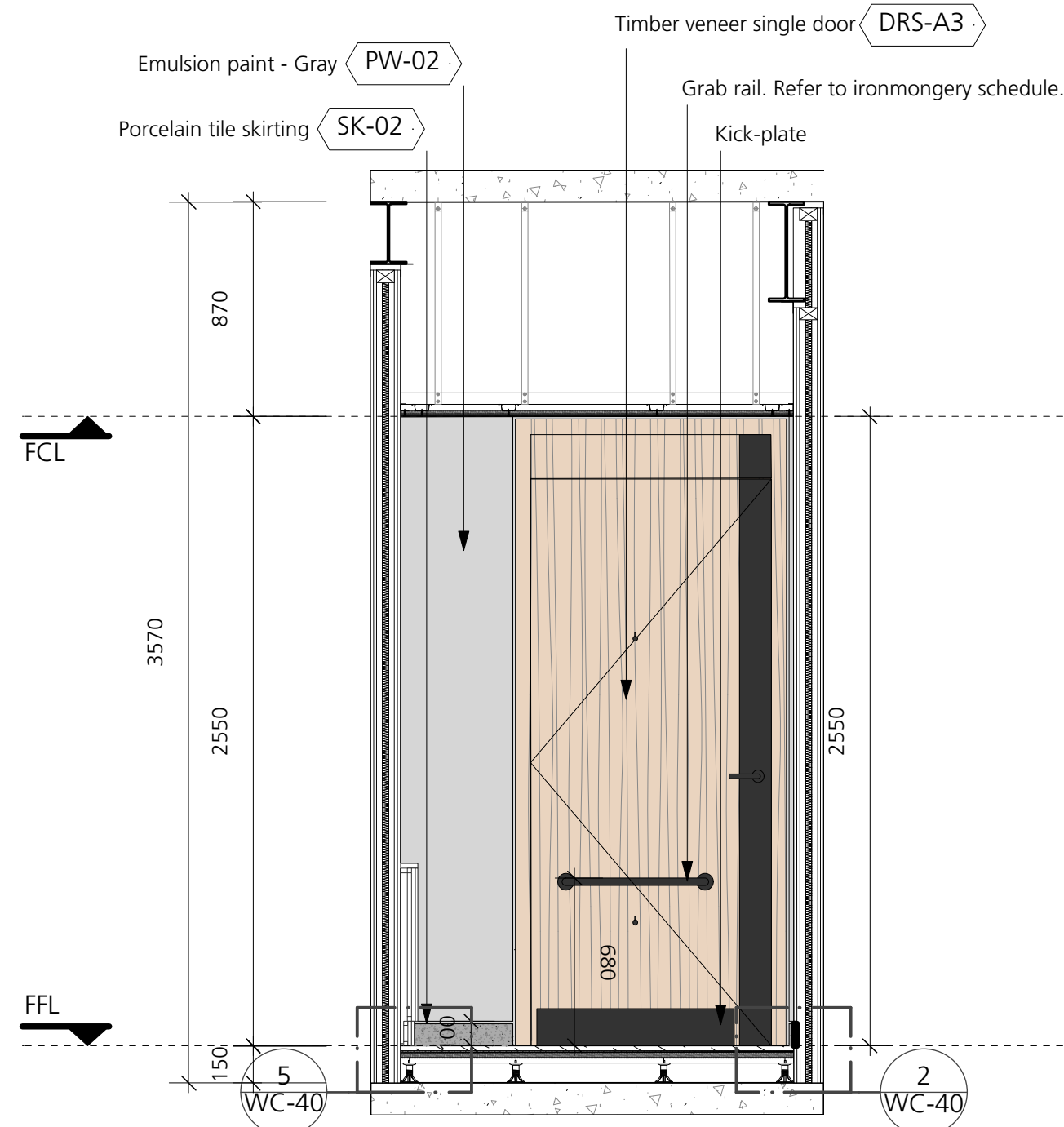

5 Proposed Accessible Toilet - Internal Elevation CC
Scale: 1:25

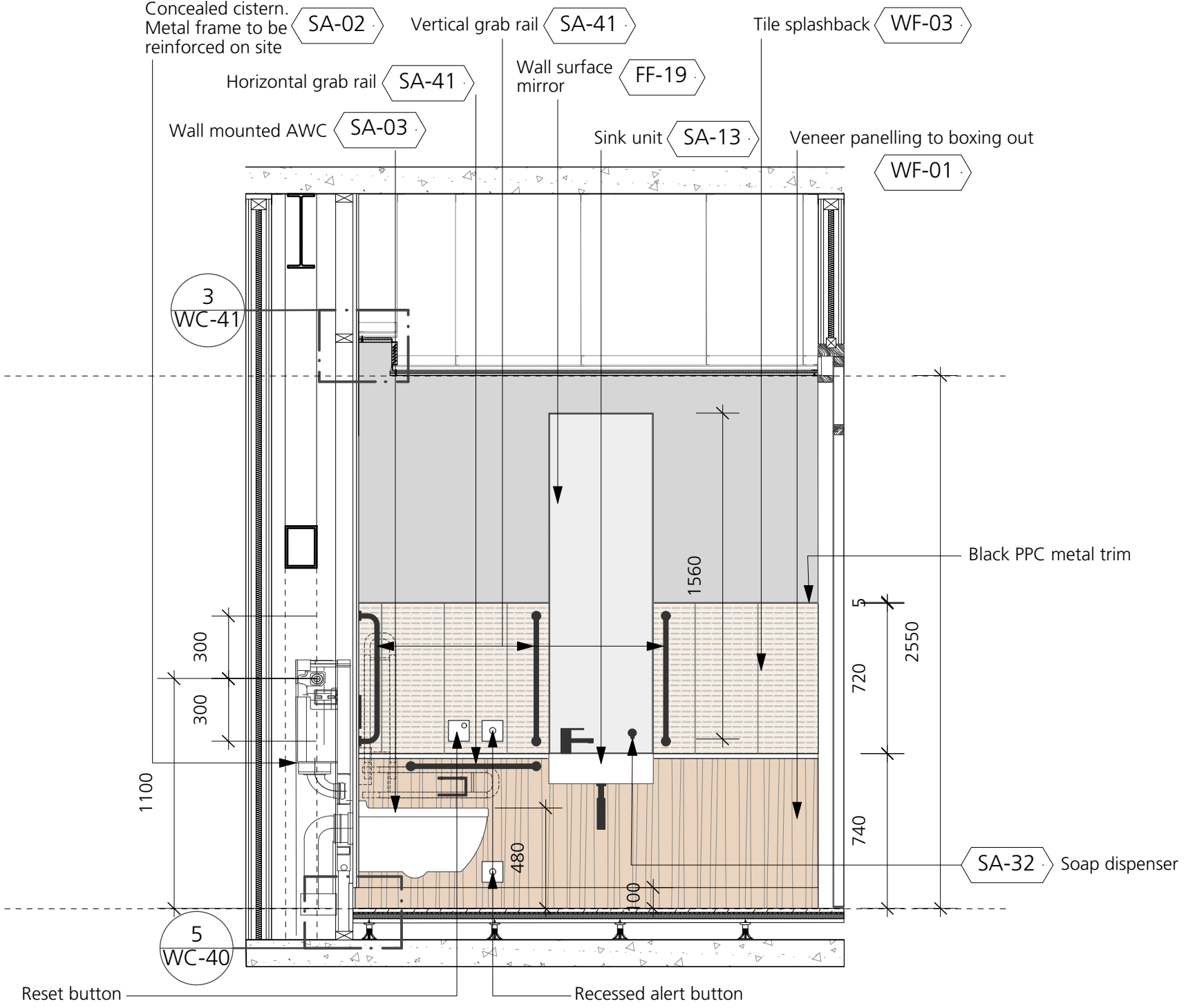

6 Proposed Accessible Toilet - Internal Elevation DD
Scale: 1:25

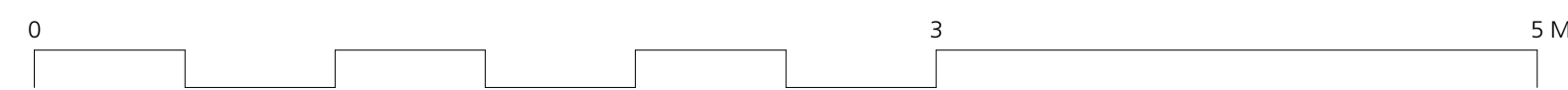

DRAWING NOTES:
All dimensions to be checked on site prior to commencement of any works, and/or preparation of any shop drawings.
Sizes of and dimensions to any structural elements are indicative only. See structural engineers drawings for actual sizes/dimensions.
Sizes of and dimensions to any service elements are indicative only. See service engineers drawings for actual sizes and dimensions.
This drawing to be read in conjunction with all other Architect's drawings, specifications and other Consultants' information.
All proprietary systems shown on this drawing are to be installed strictly in accordance with the Manufacturers/Suppliers recommended details.
Any discrepancies between information shown on this drawing and any other contract information or manufacturers/suppliers recommendations is to be brought to the attention of the Architect.
DO NOT SCALE FROM THIS DRAWING.

DRAWING NOTES:

Core and EOT lighting:

- LED strip lighting
- Recessed linear luminaire
- LED recessed downlight
- LED surface-mounted wall luminaire
- LED surface-mounted wall luminaire

Other services (refer to MEP information):

- Passive infrared sensor (PIR)
- Ceiling mounted speaker
- Combined optical multihead smoke detector
- Combined optical smoke detector and beacon
- VAD Beacon
- Daylight Sensor
- Sprinkler Head
- Exit Sign
- Linear air grille

T3
T2
T1

REVISED STAGE 4 ISSUE
REVISED STAGE 4 ISSUE
STAGE 4 ISSUE

STATUS

REVISION

DATE

07/08/19
14/06/19
04/06/19

DRAWING

Typical floor accessible toilet

SCALE

1:50 @ A1
(100 @ A3)

DATE

May 2019

DWG No.

1069_WC-05

DRAWING STATUS

STAGE 4

DRAWING FILE REF
1069-A-x-D-xx-WC

DRAWN BY
CG

REVISION
T3

Buckley Gray Yeoman

Studio 4.04 The Tea Building 56 Shoreditch High Street
London E1 6JJ T: 020 7033 9913 F: 020 7033 9914

CLIENT

25 Cannon Street Limited

PROJECT

25 Cannon Street, EC4M