

1 MA(45)0101 - Export House First Floor Ceiling Plan
EX(05)0005 Scale: 1 : 50

- Scope of Works
- Wall & wall finishes to be removed
- Floor finishes to be removed
- Suspended ceiling to be removed
- Party wall to be retained
- Architectural elements to be removed

GENERAL NOTES:

- All structural elements to be retained
- All services to be surveyed and retained where possible.
- All active power supply elements to be contained - subject to MEP engineers survey / proposal
- Remove and re-fix any ceiling mounted emergency light fittings, detectors etc.
- All loose furniture to be removed
- Existing vinyl skirtings to be surveyed by sub-contractor on site and removed if not in good condition for future use.
- No hazard elements have been identified

GENERAL NOTES:

- For demolition plan refer to BNY-EX(05)0005
- For demolition sections refer to BNY-EX(05)0007



All dimensions to be verified on site. All discrepancies to be clarified with project Architect.

This drawing is the property of Benoy Architects and is issued on the condition it is not reproduced, retained or disclosed to any unauthorised person, either wholly or in part without written consent of Benoy Ltd.

Ordnance Survey material is used with the permission of The Controller of HMSO, Crown copyright AR 159670.

The CDM hazard management procedures for the Benoy aspects of the design of this project are to be found on the "Benoy - Designer's Hazard Identification and Management Sheet" and/or drawings. The full project design teams comprehensive set of hazard management procedures are available from the Planning Supervisor/Safety Coordinator appointed for the project.

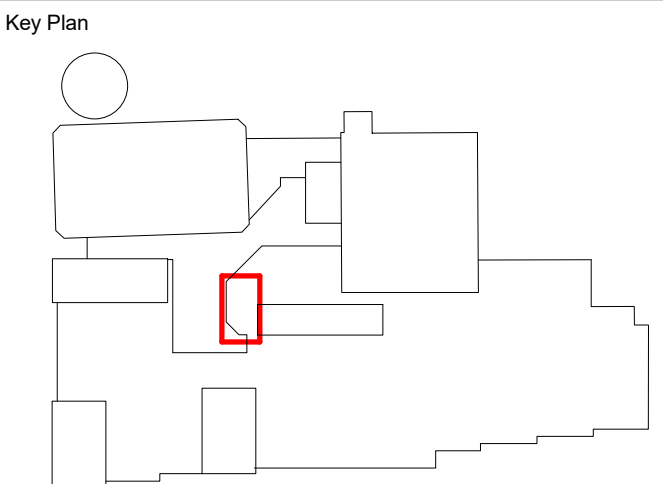
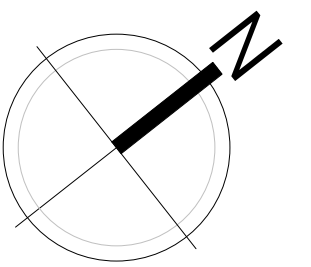

E02	13.05.20	Existing glazing system to be retained	OM	VC
E01	01.05.20	Revised notes based on comments	OM	VC
E00	24.04.20	First Issue	OM	VC

Rev	Date	Description	By	Checked
-----	------	-------------	----	---------

Client
Victoria Square Woking Limited
5 Olympus Court
Olympus Avenue
Leamington Spa, CV34 6RZ

Structural Engineer
Doran Consulting
Norwood House
96-102 Great Victoria Street
Belfast, BT2 7BE
+44 (0) 28 9033 3443

M&E Engineer
HOARE LEA
Western Transit Shed
12-13 Stable Street
London, N1C 4AB
+44 (0) 20 3668 7100

Landscape Architect
Gillespies
1 St John's Square
London
EC1M 4DH
+44 (0) 20 7253 2929

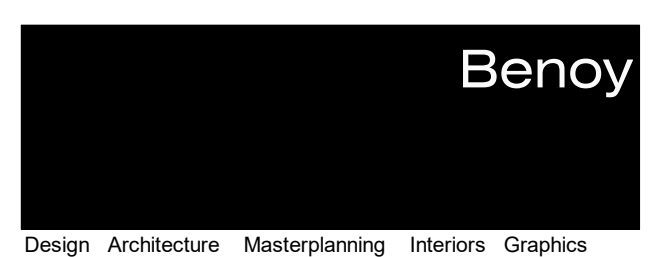

Project
VICTORIA SQUARE DEVELOPMENT, WOKING

Drawing Title
EXPORT HOUSE - TEMPORARY FACILITIES - DEMOLITION CEILING PLAN MC

Drawn By	Checked By
OM	VC

Scale @ A1	Date
As indicated	24/04/20

Project No.	Drawing No.	Rev
3540	BNY-EX(05)0006	E02

Status

FOR TENDER

www.benoy.com 1 Monkwell Square London, EC2M 9BL United Kingdom	t +44 (0)20 7726 8999 f +44 (0)20 7775 3900 e london@benoy.com
--	--