

E01	12.05.20	Tender Issue	OM	VC
E00	24.04.20	First Issue	OM	VC

Rev	Date	Description	By	Checked
-----	------	-------------	----	---------

Client

**Victoria Square Woking Limited**  
5 Olympus Court  
Olympus Avenue  
Leamington Spa, CV34 6RZ

Structural Engineer

**Doran Consulting**  
Norwood House  
96-102 Great Victoria Street  
Belfast, BT2 7BE  
+44 (0) 28 9033 3443

M&E Engineer

**HOARE LEA**  
Western Transit Shed  
12-13 Stable Street  
London, N1C 4AB  
+44 (0) 20 3668 7100

Landscape Architect

**Gillespies**  
1 St John's Square  
London  
EC1M 4DH  
+44 (0) 20 7253 2929

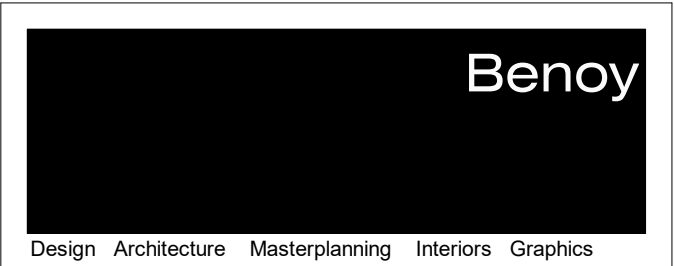

Project

VICTORIA SQUARE DEVELOPMENT,  
WOKING

Drawing Title

EXPORT HOUSE - TEMPORARY  
FACILITIES - EXISTING OFFICE  
SPACE - SAINSBURY'S DEMISE  
MC

Drawn By

OM

Checked By

VC

Scale @ A1

1 : 25

Date

24/04/20

Project No.

3540

Drawing No.

BNY-EX(20)0103

Rev

E01

Status

FOR TENDER

www.benoy.com  
1 Monkwell Square  
London, EC2M 9BL  
United Kingdom

+44 (0)20 7726 8999  
+44 (0)20 7775 3900  
e london@benoy.com

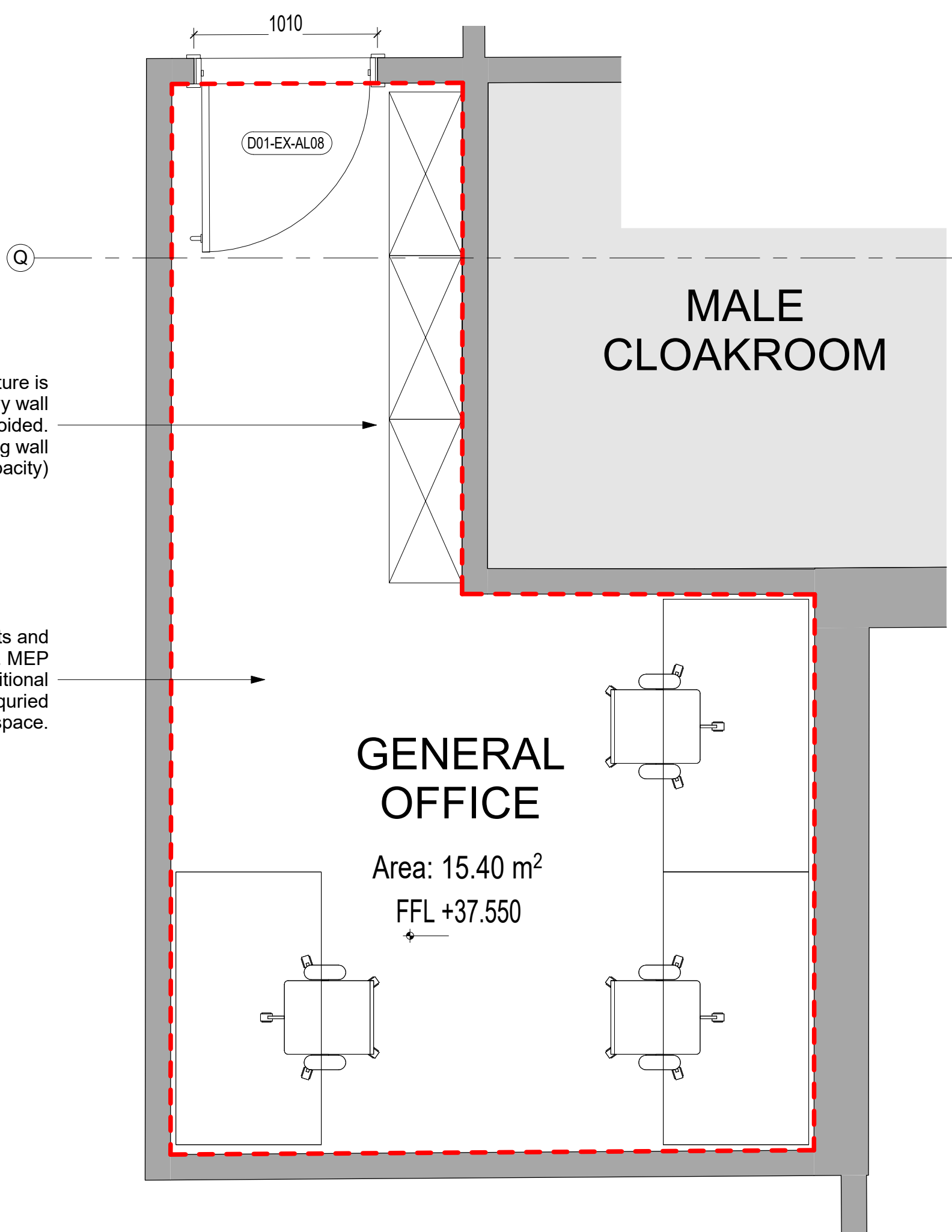

Floor standing furniture is recommended. Heavy wall mounted furniture to be avoided. (No information over existing wall build-up and loading capacity)

Survey of existing sockets and conduits to be carried out. MEP engineers to assess if additional power & data supply is required for office space.

2 MA(20)0101 - Export House First Floor Plan Sainsbury's Office space furniture proposal

Scale: 1 : 25

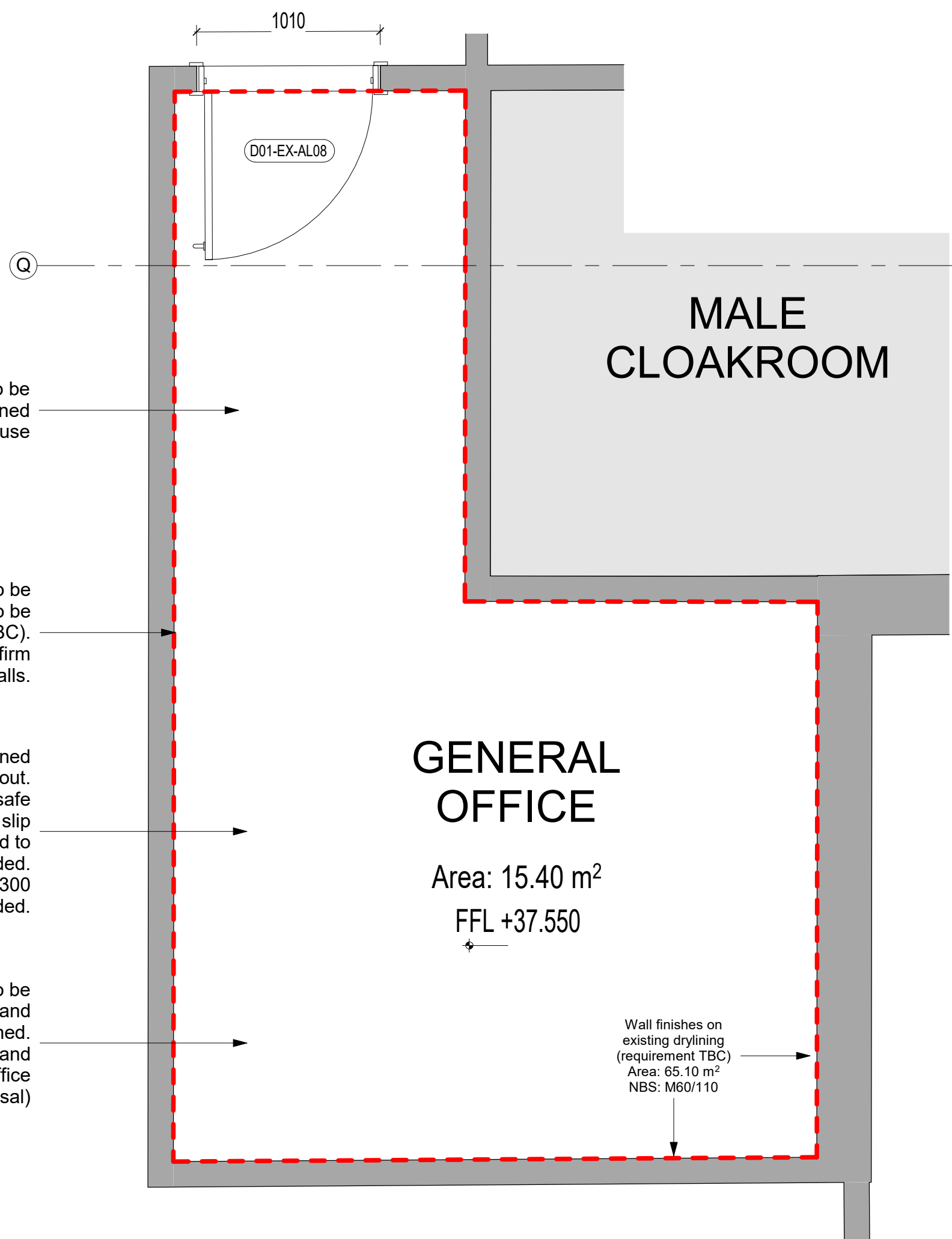

All loose furniture to be removed. Room to be cleaned and prepared for use

Existing partition walls to be retained. Internal finishes to be re-applied for uniform look (TBC). Sub-contractor to confirm condition of existing walls.

Existing floor finishes to be retained and cleaned prior to fitting-out. If new floor is required Polysafe Astral PUR heavy duty high slip resistant vinyl flooring fixed to concrete slab to be provided. Colour: Starburst, 4300 Leveling compound to be provided.

Existing suspended ceiling to be retained. Lighting fixtures and existing services to be retained. Lux levels to be checked and assess if suitable for office space (subject to MEP proposal)

Wall finishes on existing drylining (requirement TBC)  
Area: 65.10 m²  
NBS: M60/110

1 MA(20)0101 - Export House First Floor Plan Sainsbury's Office space

Scale: 1 : 25

#### GENERAL NOTES:

- All structural elements to be retained
- All services to be surveyed and retained where possible.
- All active power supply elements to be contained - refer to MEP engineer's drawings and spec for detail
- Highlighted areas indicative only. Site survey required to determine exact areas.

#### GENERAL NOTES:

- For scope plan refer to BNY-EX(20)0101
- For ceiling plan & sections drawings of "Temp Facility" area refer to EX(20)0102, EX(22)AL01, EX(45)0102
- For paintings & wall finishes refer to BNY-SA-99-XX-A-M60
- Refer to NBS specification Z99

0.5 0 0.5 1 1.5 2 2.5  
Unit Value : Metres